

# No.25

# Stock Sprockets

Pitch  $\frac{1}{4}$ "       Roller  $\phi$  0.130"  
 Tooth width B1 0.110"

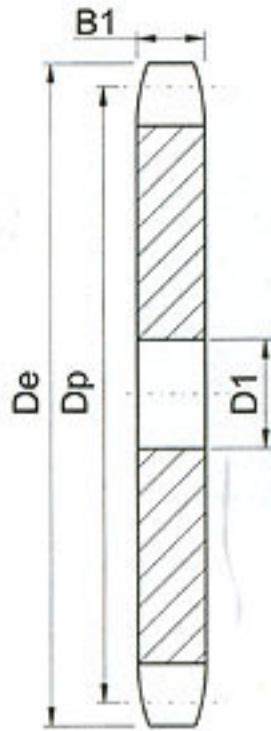

TYPE A

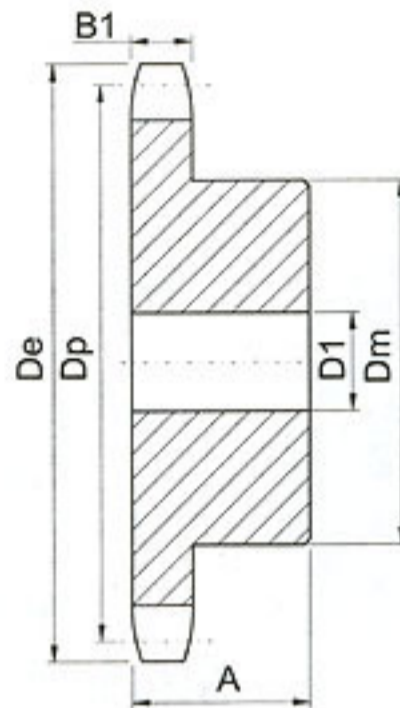

TYPE B

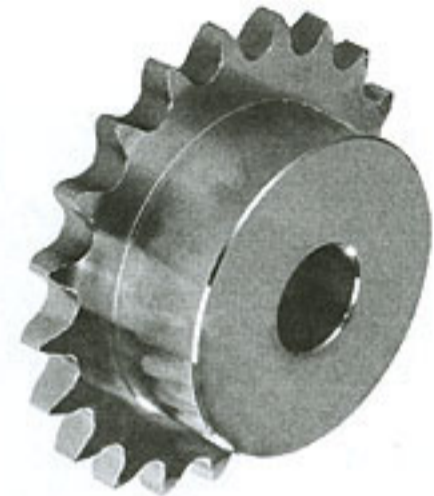

## Single-Type A

## Single-Type B

No. Teeth	De	Type	SZS Number	D1	Weight Lbs. (Approx.)	SZS Number	Type	D1		Dm	A	Weight Lbs. (Approx.)
								Min	Max.			
9	.837					25B9	B	$\frac{1}{4}$	$\frac{1}{4}$	$\frac{7}{16}$	$\frac{1}{2}$	.03
10	.919					25B10	B	$\frac{1}{4}$	$\frac{1}{4}$	$\frac{1}{2}$	$\frac{1}{2}$	.03
11	1.002					25B11	B	$\frac{1}{4}$	$\frac{5}{16}$	$\frac{9}{16}$	$\frac{1}{2}$	.04
12	1.083					25B12	B	$\frac{1}{4}$	$\frac{3}{8}$	$\frac{5}{8}$	$\frac{1}{2}$	.06
13	1.167					25B13	B	$\frac{1}{4}$	$\frac{7}{16}$	$\frac{23}{32}$	$\frac{1}{2}$	.07
14	1.246					25B14	B	$\frac{1}{4}$	$\frac{9}{16}$	$\frac{13}{16}$	$\frac{1}{2}$	.08
15	1.326					25B15	B	$\frac{1}{4}$	$\frac{9}{16}$	$\frac{5}{8}$	$\frac{1}{2}$	.10
16	1.407					25B16	B	$\frac{1}{4}$	$\frac{9}{16}$	$\frac{3}{32}$	$\frac{1}{2}$	.12
17	1.487					25B17	B	$\frac{1}{4}$	$\frac{5}{8}$	$\frac{13}{32}$	$\frac{1}{2}$	.14
18	1.568	A	25A18	$\frac{1}{4}$	.04	25B18	B	$\frac{1}{4}$	$\frac{3}{4}$	$\frac{1}{8}$	$\frac{1}{2}$	.16
19	1.648	A	25A19	$\frac{1}{4}$	.04	25B19	B	$\frac{1}{4}$	$\frac{13}{16}$	$\frac{13}{32}$	$\frac{1}{2}$	.19
20	1.729	A	25A20	$\frac{1}{4}$	.04	25B20	B	$\frac{1}{4}$	$\frac{7}{8}$	$\frac{13}{32}$	$\frac{5}{8}$	.25
21	1.809	A	25A21	$\frac{3}{8}$	.04	25B21	B	$\frac{1}{4}$	$\frac{7}{8}$	$\frac{1}{8}$	$\frac{5}{8}$	.28
22	1.889	A	25A22	$\frac{3}{8}$	.06	25B22	B	$\frac{1}{4}$	$\frac{15}{16}$	$\frac{17}{16}$	$\frac{5}{8}$	.31
23	1.969	A	25A23	$\frac{3}{8}$	.06	25B23	B	$\frac{1}{4}$	1	$\frac{1}{2}$	$\frac{5}{8}$	.32
24	2.049	A	25A24	$\frac{3}{8}$	.08	25B24	B	$\frac{3}{8}$	1	$\frac{1}{2}$	$\frac{5}{8}$	.33
25	2.129	A	25A25	$\frac{3}{8}$	.08	25B25	B	$\frac{3}{8}$	1	$\frac{1}{2}$	$\frac{5}{8}$	.34
26	2.209	A	25A26	$\frac{3}{8}$	.09	25B26	B	$\frac{3}{8}$	1	$\frac{1}{2}$	$\frac{5}{8}$	.35
28	2.369	A	25A28	$\frac{3}{8}$	.10	25B28	B	$\frac{3}{8}$	1	$\frac{1}{2}$	$\frac{5}{8}$	.36
30	2.529	A	25A30	$\frac{3}{8}$	.12	25B30	B	$\frac{3}{8}$	1	$\frac{1}{2}$	$\frac{5}{8}$	.38
32	2.688	A	25A32	$\frac{3}{8}$	.14	25B32	B	$\frac{3}{8}$	1	$\frac{1}{2}$	$\frac{5}{8}$	.40
35	2.928	A	25A35	$\frac{3}{8}$	.16							
36	3.008	A	25A36	$\frac{3}{8}$	.18	25B36	B	$\frac{3}{8}$	1	$\frac{1}{2}$	$\frac{3}{4}$	.50
40	3.327	A	25A40	$\frac{1}{2}$	.20	25B40	B	$\frac{1}{2}$	$\frac{13}{8}$	2	$\frac{3}{4}$	.53
42	3.486	A	25A42	$\frac{1}{2}$	.24							
45	3.725	A	25A45	$\frac{1}{2}$	.25	25B45	B	$\frac{1}{2}$	$\frac{13}{8}$	2	$\frac{3}{4}$	.56
48	3.964	A	25A48	$\frac{1}{2}$	.32	25B48	B	$\frac{1}{2}$	$\frac{13}{8}$	2	$\frac{3}{4}$	.56
54	4.442	A	25A54	$\frac{1}{2}$	.38	25B54	B	$\frac{1}{2}$	$\frac{13}{8}$	2	$\frac{3}{4}$	1.00
60	4.920	A	25A60	$\frac{1}{2}$	.54	25B60	B	$\frac{1}{2}$	$\frac{13}{8}$	2	$\frac{3}{4}$	1.10
70	5.717					25B70	B	$\frac{1}{2}$	$\frac{13}{8}$	2	$\frac{3}{4}$	1.25
72	5.876	A	25A72	$\frac{1}{2}$	.74	25B72	B	$\frac{1}{2}$	$\frac{13}{8}$	2	$\frac{3}{4}$	1.30

# No.35

# Stock Sprockets

- Pitch  $\frac{3}{8}$ "      Roller  $\Phi$  0.200"  
 Tooth width B1 0.168"

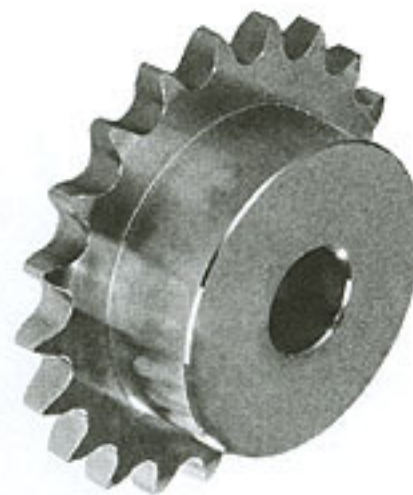
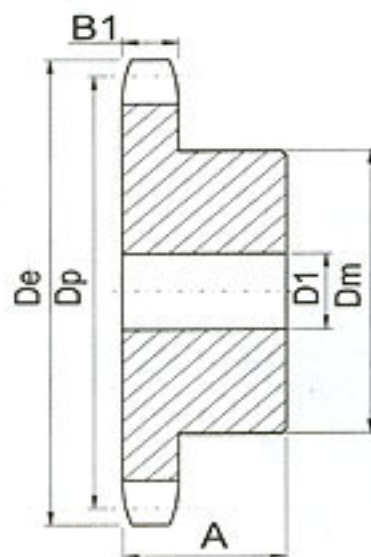
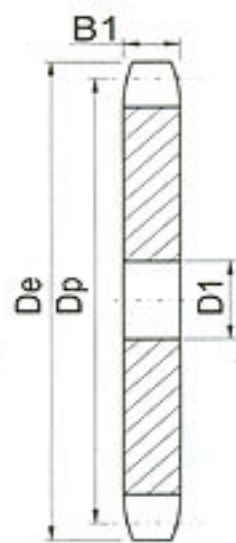

TYPE A

TYPE B

Single-Type A

Single-Type B

No. Teeth	De	Type	SZS Number	D1	Weight Lbs. (Approx.)	SZS Number	Type	D1		Dm	A	Weight Lbs. (Approx.)
								Min	Max.			
8	1.130					35B8	B	$\frac{3}{8}$	$\frac{3}{8}$	$\frac{3}{8}$ ★	$\frac{3}{8}$	.07
9	1.260					35B9	B	$\frac{3}{8}$	$\frac{3}{8}$	$\frac{27}{32}$ ★	$\frac{3}{8}$	.09
10	1.380					35B10	B	$\frac{3}{8}$	$\frac{9}{16}$	$\frac{37}{32}$ ★	$\frac{3}{8}$	.14
11	1.500					35B11	B	$\frac{3}{8}$	$\frac{9}{16}$	$1\frac{1}{16}$ ★	$\frac{3}{8}$	.17
12	1.630					35B12	B	$\frac{1}{2}$	$\frac{9}{16}$	$1\frac{17}{32}$ ★	$\frac{3}{8}$	.20
13	1.750					35B13	B	$\frac{1}{2}$	$1\frac{1}{16}$	$1\frac{1}{4}$ ★	$\frac{3}{8}$	.23
14	1.870					35B14	B	$\frac{1}{2}$	$\frac{7}{8}$	$1\frac{1}{4}$	$\frac{3}{8}$	.25
15	1.990	A	35A15	$\frac{1}{2}$	.10	35B15	B	$\frac{1}{2}$	$\frac{7}{8}$	$1\frac{17}{32}$	$\frac{3}{8}$	.29
16	2.110	A	35A16	$\frac{1}{2}$	.12	35B16	B	$\frac{1}{2}$	$1\frac{1}{16}$	$1\frac{17}{32}$	$\frac{3}{8}$	.35
17	2.230	A	35A17	$\frac{1}{2}$	.12	35B17	B	$\frac{1}{2}$	$1\frac{1}{16}$	$1\frac{19}{32}$	$\frac{3}{8}$	.42
18	2.350	A	35A18	$\frac{1}{2}$	.14	35B18	B	$\frac{1}{2}$	$1\frac{1}{16}$	$1\frac{23}{32}$	$\frac{3}{8}$	.48
19	2.470	A	35A19	$\frac{1}{2}$	.16	35B19	B	$\frac{1}{2}$	$1\frac{1}{4}$	$1\frac{27}{32}$	$\frac{3}{8}$	.54
20	2.590	A	35A20	$\frac{1}{2}$	.20	35B20	B	$\frac{1}{2}$	$1\frac{5}{8}$	$1\frac{17}{16}$	$\frac{3}{8}$	.59
21	2.710	A	35A21	$\frac{1}{2}$	.20	35B21	B	$\frac{1}{2}$	$1\frac{7}{8}$	2	$\frac{7}{8}$	.80
22	2.830	A	35A22	$\frac{1}{2}$	.22	35B22	B	$\frac{1}{2}$	$1\frac{7}{8}$	2	$\frac{7}{8}$	.80
23	2.950	A	35A23	$\frac{1}{2}$	.24	35B23	B	$\frac{1}{2}$	$1\frac{7}{8}$	2	$\frac{7}{8}$	.82
24	3.070	A	35A24	$\frac{1}{2}$	.26	35B24	B	$\frac{1}{2}$	$1\frac{7}{8}$	2	$\frac{7}{8}$	.88
25	3.190	A	35A25	$\frac{1}{2}$	.28	35B25	B	$\frac{1}{2}$	$1\frac{7}{8}$	2	$\frac{7}{8}$	.88
26	3.310	A	35A26	$\frac{1}{2}$	.28	35B26	B	$\frac{1}{2}$	$1\frac{7}{8}$	2	$\frac{7}{8}$	.90
27	3.430	A	35A27	$\frac{1}{2}$	.34	35B27	B	$\frac{1}{2}$	$1\frac{7}{8}$	2	$\frac{7}{8}$	.94
28	3.550	A	35A28	$\frac{1}{2}$	.34	35B28	B	$\frac{1}{2}$	$1\frac{7}{8}$	2	$\frac{7}{8}$	.94
30	3.790	A	35A30	$\frac{1}{2}$	.46	35B30	B	$\frac{1}{2}$	$1\frac{7}{8}$	2	$\frac{7}{8}$	1.02
32	4.030	A	35A32	$\frac{5}{8}$	.46	35B32	B	$\frac{1}{2}$	$1\frac{7}{8}$	2	$\frac{7}{8}$	1.24
35	4.390	A	35A35	$\frac{5}{8}$	.60	35B35	B	$\frac{3}{8}$	$1\frac{1}{2}$	$2\frac{1}{4}$	$\frac{7}{8}$	1.50
36	4.510	A	35A36	$\frac{5}{8}$	.62	35B36	B	$\frac{3}{8}$	$1\frac{1}{2}$	$2\frac{1}{4}$	$\frac{7}{8}$	1.56
40	4.990	A	35A40	$1\frac{1}{32}$	.70	35B40	B	$\frac{3}{8}$	$1\frac{1}{2}$	$2\frac{1}{4}$	1	1.62
42	5.230	A	35A42	$1\frac{1}{32}$	.78	35B42	B	$\frac{3}{8}$	$1\frac{1}{2}$	$2\frac{1}{4}$	1	1.68
45	5.590	A	35A45	$1\frac{1}{32}$	.88	35B45	B	$\frac{3}{8}$	$1\frac{1}{2}$	$2\frac{1}{4}$	1	1.78
48	5.950	A	35A48	$1\frac{1}{32}$	1.21	35B48	B	$\frac{3}{8}$	$1\frac{1}{2}$	$2\frac{1}{4}$	1	1.88
54	6.660	A	35A54	$1\frac{1}{32}$	1.32	35B54	B	$\frac{3}{8}$	$1\frac{1}{2}$	$2\frac{1}{4}$	1	2.20
60	7.380	A	35A60	$2\frac{3}{32}$	1.66	35B60	B	$\frac{3}{4}$	$1\frac{1}{2}$	$2\frac{1}{4}$	1	2.48
70	8.580	A	35A70	$2\frac{3}{32}$	2.30	35B70	B	$\frac{3}{4}$	$1\frac{1}{2}$	$2\frac{1}{4}$	1	3.12
72	8.810	A	35A72	$2\frac{3}{32}$	2.56	35B72	B	$\frac{3}{4}$	$1\frac{1}{2}$	$2\frac{1}{4}$	1	3.42
80	9.770	A	35A80	$2\frac{3}{32}$	3.16	35B80	B	$\frac{3}{4}$	$1\frac{1}{2}$	$2\frac{1}{4}$	1	3.82
84	10.250	A	35A84	$2\frac{3}{32}$	3.26	35B84	B	$\frac{3}{4}$	$1\frac{1}{2}$	$2\frac{1}{4}$	1	4.24
96	11.680	A	35A96	$2\frac{3}{32}$	4.64	35B96	B	$\frac{3}{4}$	$1\frac{1}{2}$	$2\frac{1}{4}$	1	5.16
112	13.590	A	35A112	$2\frac{3}{32}$	5.05	35B112	B	$\frac{3}{4}$	$1\frac{1}{2}$	$2\frac{1}{4}$	1	6.70

# No.35-2 Stock Sprockets

- Pitch  $\frac{3}{8}$ "
- Roller  $\phi$  0.200"
- Tooth width b1 0.162"
- Tooth width B2 0.561"

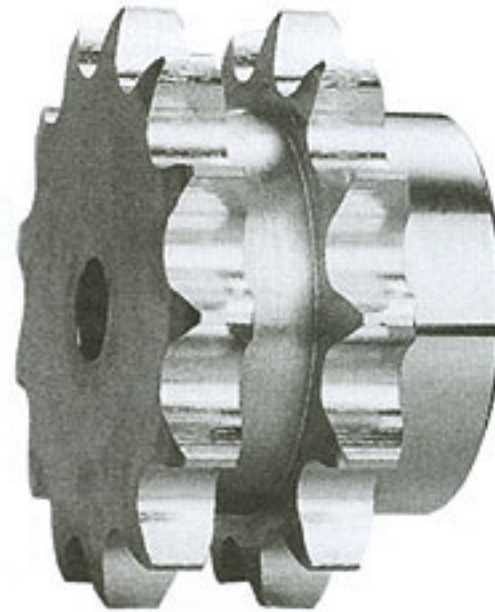
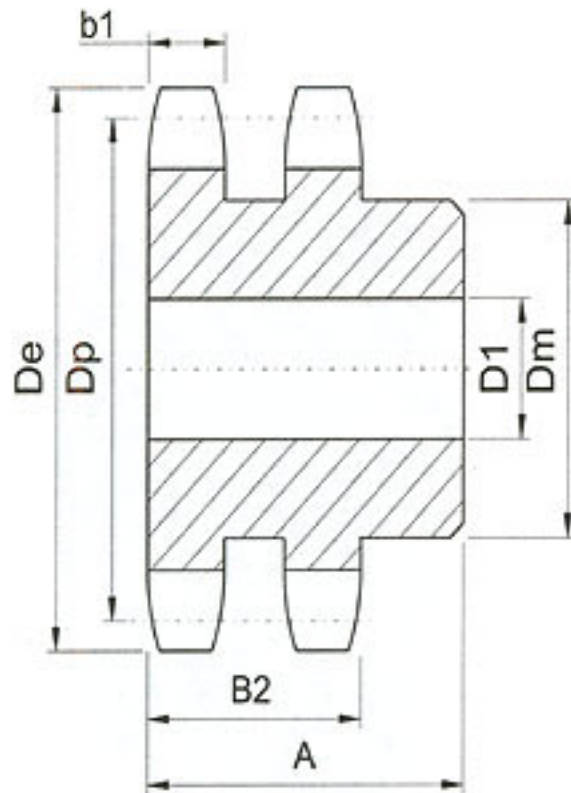

**TYPE B**

## Double-Type B

No. Teeth	SZS Number	De	Type	D1		Dm	A	Weight Lbs. (Approx.)
				Min.	Max.			
12	D35B12H	1.630	B	$\frac{1}{2}$	$\frac{5}{16}$	$\frac{3}{4}$	$\frac{1}{4}$	.32
13	D35B13H	1.750	B	$\frac{1}{2}$	$\frac{1}{4}$	$\frac{1}{4}$	$\frac{1}{4}$	.36
14	D35B14H	1.870	B	$\frac{1}{2}$	$\frac{7}{16}$	$\frac{1}{4}$	$\frac{1}{4}$	.44
15	D35B15H	1.990	B	$\frac{1}{2}$	$\frac{1}{4}$	$\frac{1}{2}$	$\frac{1}{4}$	.56
16	D35B16H	2.110	B	$\frac{1}{2}$	$\frac{1}{4}$	$\frac{1}{2}$	$\frac{1}{4}$	.64
17	D35B17H	2.230	B	$\frac{1}{2}$	$\frac{1}{4}$	$\frac{1}{2}$	$\frac{1}{4}$	.74
18	D35B18H	2.350	B	$\frac{1}{2}$	$\frac{1}{4}$	$\frac{1}{2}$	$\frac{1}{4}$	.84
19	D35B19H	2.470	B	$\frac{1}{2}$	$\frac{1}{4}$	$\frac{1}{4}$	$\frac{1}{4}$	.96
20	D35B20H	2.590	B	$\frac{3}{4}$	$\frac{1}{4}$	$\frac{1}{4}$	$\frac{1}{8}$	1.08
21	D35B21H	2.710	B	$\frac{3}{4}$	$\frac{1}{4}$	$\frac{2}{4}$	$\frac{1}{8}$	1.24
22	D35B22H	2.830	B	$\frac{3}{4}$	$\frac{1}{4}$	$\frac{2}{4}$	$\frac{1}{8}$	1.42
23	D35B23H	2.950	B	$\frac{3}{4}$	$\frac{1}{2}$	$\frac{2}{4}$	$\frac{1}{8}$	1.54
24	D35B24H	3.070	B	$\frac{3}{4}$	$\frac{1}{2}$	$\frac{2}{4}$	$\frac{1}{8}$	1.62
25	D35B25H	3.190	B	$\frac{3}{4}$	$\frac{1}{2}$	$\frac{2}{4}$	$\frac{1}{8}$	1.66
26	D35B26	3.310	B	$\frac{3}{4}$	$\frac{1}{2}$	$\frac{2}{4}$	$\frac{1}{8}$	1.98
30	D35B30	3.790	B	$\frac{3}{4}$	$\frac{1}{2}$	$\frac{2}{4}$	$\frac{1}{8}$	2.34
36	D35B36	4.510	B	$\frac{3}{4}$	$\frac{1}{2}$	$\frac{2}{4}$	$\frac{1}{8}$	3.00
42	D35B42	5.230	B	$\frac{3}{4}$	$\frac{1}{2}$	$\frac{2}{4}$	$\frac{1}{8}$	3.80
48	D35B48	5.950	B	$\frac{3}{4}$	$\frac{1}{2}$	$\frac{2}{4}$	$\frac{1}{8}$	4.66
52	D35B52	6.430	B	$\frac{3}{4}$	$\frac{1}{2}$	$\frac{2}{4}$	$\frac{1}{8}$	5.40
60	D35B60	7.380	B	$\frac{3}{4}$	$\frac{1}{2}$	$\frac{2}{4}$	$\frac{1}{8}$	6.84
68	D35B68	8.340	B	$\frac{3}{4}$	$\frac{2}{4}$	$\frac{3}{4}$	$\frac{1}{2}$	10.01
72	D35B72	8.810	B	$\frac{3}{4}$	$\frac{2}{4}$	$\frac{3}{4}$	$\frac{1}{2}$	11.04
76	D35B76	9.290	B	$\frac{3}{4}$	$\frac{2}{4}$	$\frac{3}{4}$	$\frac{1}{2}$	11.94
84	D35B84	10.250	B	$\frac{3}{4}$	$\frac{2}{4}$	$\frac{3}{4}$	$\frac{1}{2}$	14.98
95	D35B95	11.560	B	1	$\frac{2}{4}$	$\frac{3}{4}$	$\frac{1}{2}$	17.42
96	D35B96	11.680	B	1	$\frac{2}{4}$	$\frac{3}{4}$	$\frac{1}{2}$	18.14
102	D35B102	12.400	B	1	$\frac{2}{4}$	$\frac{3}{4}$	$\frac{1}{2}$	19.92

Maximum bores shown will accommodate standard keyseat and setscrew over keyseat.

Slightly larger bores are possible with no keyseat, shallow keyseat, or setscrew at angle to keyseat.

# No.35-3 Stock Sprockets

- Pitch  $\frac{3}{8}$ "       Roller  $\phi$  0.200"  
 Tooth width b1 0.162"       Tooth width B2 0.561"       Tooth width B3 0.960"

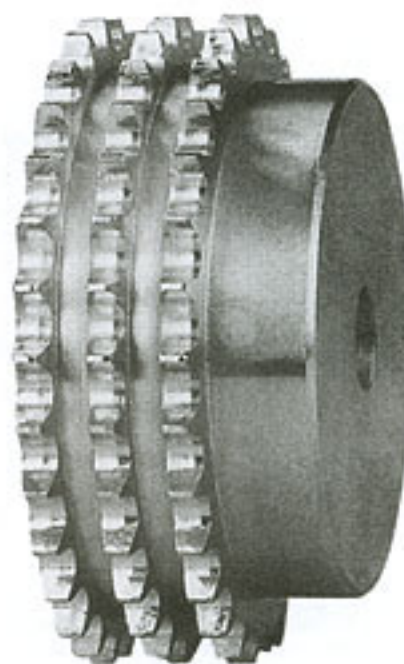
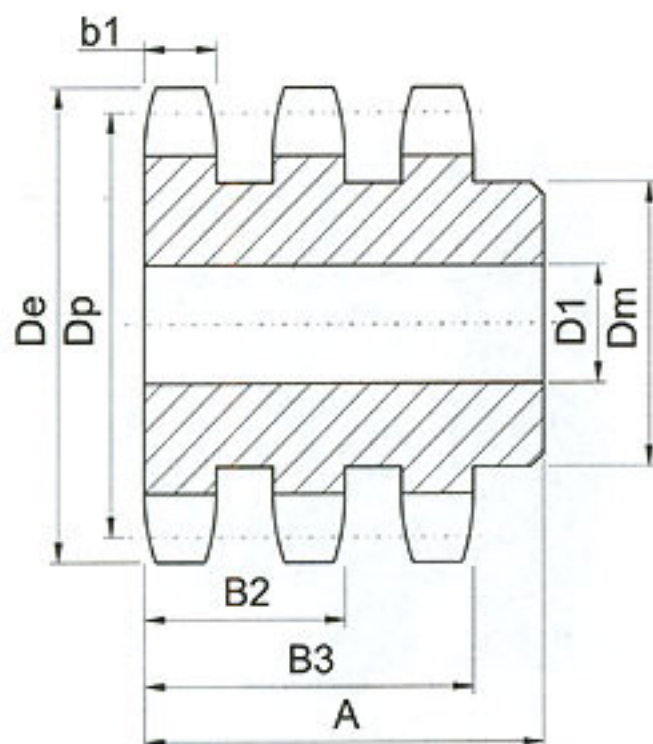

**TYPE B**

## Triple-Type B

No. Teeth	SZS Number	De	Type	D1		Dm	A	Weight Lbs. (Approx.)
				Min.	Max.			
13	E35B13H	1.750	B	$\frac{1}{2}$	$\frac{1}{16}$	$\frac{1}{4}$	$\frac{1}{2}$	.50
14	E35B14H	1.870	B	$\frac{1}{2}$	$\frac{7}{16}$	$\frac{1}{2}$	$\frac{1}{2}$	.62
15	E35B15H	1.990	B	$\frac{1}{2}$	$\frac{1}{8}$	$\frac{1}{2}$	$\frac{1}{2}$	.78
16	E35B16H	2.110	B	$\frac{1}{2}$	$\frac{1}{8}$	$\frac{1}{2}$	$\frac{1}{2}$	.82
17	E35B17H	2.230	B	$\frac{1}{2}$	$\frac{1}{8}$	$\frac{1}{2}$	$\frac{1}{2}$	1.04
18	E35B18H	2.350	B	$\frac{1}{2}$	$\frac{1}{8}$	$\frac{1}{2}$	$\frac{1}{2}$	1.22
19	E35B19H	2.470	B	$\frac{1}{2}$	$\frac{1}{8}$	$\frac{1}{2}$	$\frac{1}{2}$	1.40
20	E35B20H	2.590	B	$\frac{3}{4}$	$\frac{1}{8}$	$\frac{1}{2}$	$\frac{1}{2}$	1.50
21	E35B21H	2.710	B	$\frac{3}{4}$	$\frac{1}{8}$	$2\frac{1}{8}$	$\frac{1}{2}$	1.72
22	E35B22H	2.830	B	$\frac{3}{4}$	$\frac{1}{8}$	$2\frac{1}{8}$	$\frac{1}{2}$	1.96
23	E35B23H	2.950	B	$\frac{3}{4}$	$\frac{1}{2}$	$2\frac{1}{4}$	$\frac{1}{2}$	2.12
24	E35B24H	3.070	B	$\frac{3}{4}$	$\frac{1}{2}$	$2\frac{1}{4}$	$\frac{1}{2}$	2.26
25	E35B25H	3.190	B	$\frac{3}{4}$	$\frac{1}{2}$	$2\frac{1}{4}$	$\frac{1}{2}$	2.42
26	E35B26	3.310	B	$\frac{3}{4}$	$\frac{1}{2}$	$2\frac{1}{2}$	$\frac{1}{2}$	2.78
30	E35B30	3.790	B	$\frac{3}{4}$	$1\frac{1}{4}$	$2\frac{1}{2}$	$\frac{1}{2}$	3.42
36	E35B36	4.510	B	$\frac{3}{4}$	$1\frac{1}{4}$	$2\frac{1}{2}$	$\frac{1}{2}$	4.52
42	E35B42	5.230	B	$\frac{3}{4}$	$1\frac{1}{4}$	$2\frac{1}{2}$	$\frac{1}{2}$	5.88
48	E35B48	5.950	B	$\frac{3}{4}$	$1\frac{1}{4}$	$2\frac{1}{2}$	$\frac{1}{2}$	7.42
52	E35B52	6.430	B	$\frac{3}{4}$	$1\frac{1}{4}$	$2\frac{1}{2}$	$\frac{1}{2}$	8.52
60	E35B60	7.380	B	$\frac{3}{4}$	$1\frac{1}{4}$	$2\frac{1}{2}$	$\frac{1}{2}$	11.22
68	E35B68	8.340	B	$\frac{3}{4}$	$2\frac{3}{8}$	$3\frac{1}{2}$	$\frac{1}{2}$	15.38
72	E35B72	8.810	B	$\frac{3}{4}$	$2\frac{3}{8}$	$3\frac{1}{2}$	$\frac{1}{2}$	17.34
76	E35B76	9.290	B	$\frac{3}{4}$	$2\frac{3}{8}$	$3\frac{1}{2}$	$\frac{1}{2}$	18.90
84	E35B84	10.250	B	$\frac{3}{4}$	$2\frac{3}{8}$	$3\frac{1}{2}$	$\frac{1}{2}$	22.82
95	E35B95	11.560	B	1	$2\frac{1}{2}$	$3\frac{3}{4}$	$2\frac{1}{2}$	29.32
96	E35B96	11.680	B	1	$2\frac{1}{2}$	$3\frac{3}{4}$	$2\frac{1}{2}$	30.06
102	E35B102	12.400	B	1	$2\frac{1}{2}$	$3\frac{3}{4}$	$2\frac{1}{2}$	33.36

# No.41

# Stock Sprockets

- Pitch  $\frac{1}{2}$ "      Roller  $\Phi$  0.306"  
 Tooth width B1 0.227"

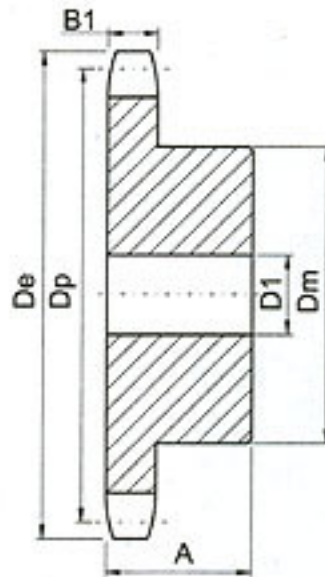
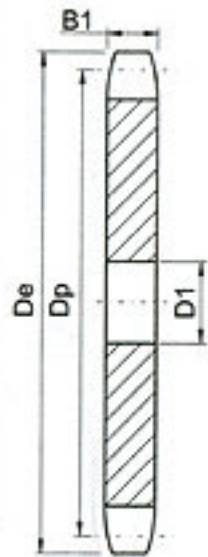

TYPE A

TYPE B

## Single-Type A

## Single-Type B

No. Teeth	De	Type	SZS Number	D1	Weight Lbs. (Approx.)	SZS Number	Type	D1		Dm	A	Weight Lbs. (Approx.)
								Min.	Max.			
6	1.170					41B6	B	$\frac{3}{8}$	$\frac{3}{8}$	$2\frac{1}{32}$ ★	$\frac{7}{8}$	.07
7	1.340					41B7	B	$\frac{3}{8}$	$\frac{3}{8}$	$\frac{3}{4}$ ★	$\frac{7}{8}$	.10
8	1.510					41B8	B	$\frac{1}{2}$	$\frac{1}{2}$	$6\frac{3}{64}$ ★	$\frac{7}{8}$	.19
9	1.670					41B9	B	$\frac{1}{2}$	$\frac{5}{8}$	$1\frac{1}{8}$ ★	$\frac{7}{8}$	.20
10	1.840					41B10	B	$\frac{1}{2}$	$\frac{3}{4}$	$1\frac{1}{4}$ ★	$\frac{7}{8}$	.27
11	2.000					41B11	B	$\frac{1}{2}$	$\frac{3}{4}$	$1\frac{3}{16}$ ★	$\frac{7}{8}$	.35
12	2.170					41B12	B	$\frac{1}{2}$	$1\frac{1}{16}$	$1\frac{1}{8}$ ★	$\frac{7}{8}$	.44
13	2.330					41B13	B	$\frac{1}{2}$	1	$1\frac{1}{8}$	$\frac{7}{8}$	.50
14	2.490					41B14	B	$\frac{1}{2}$	$1\frac{1}{4}$	$1\frac{3}{8}$	$\frac{7}{8}$	.57
15	2.650	A	41A15	$\frac{5}{8}$	.28	41B15	B	$\frac{1}{2}$	$1\frac{1}{8}$	$1\frac{7}{16}$	$\frac{7}{8}$	.72
16	2.810	A	41A16	$\frac{5}{8}$	.34	41B16	B	$\frac{5}{8}$	$1\frac{1}{8}$	$2\frac{1}{16}$	$\frac{7}{8}$	.91
17	2.980	A	41A17	$\frac{5}{8}$	.36	41B17	B	$\frac{5}{8}$	$1\frac{1}{2}$	$2\frac{1}{8}$	1	1.09
18	3.140	A	41A18	$\frac{5}{8}$	.44	41B18	B	$\frac{5}{8}$	1 $\frac{1}{8}$	$2\frac{3}{8}$	1	1.25
19	3.300	A	41A19	$\frac{5}{8}$	.46	41B19	B	$\frac{5}{8}$	$1\frac{1}{4}$	$2\frac{1}{2}$	1	1.49
20	3.460	A	41A20	$\frac{5}{8}$	.52	41B20	B	$\frac{5}{8}$	1 $\frac{1}{8}$	$2\frac{3}{4}$	1	1.64
21	3.620	A	41A21	$\frac{5}{8}$	.60	41B21	B	$\frac{5}{8}$	1 $\frac{1}{8}$	$2\frac{3}{4}$	1	1.81
22	3.780	A	41A22	$\frac{5}{8}$	.66	41B22	B	$\frac{5}{8}$	2	3	1	1.93
23	3.940	A	41A23	$\frac{5}{8}$	.72	41B23	B	$\frac{5}{8}$	$2\frac{1}{4}$	$3\frac{1}{16}$	1	2.25
24	4.100	A	41A24	$\frac{5}{8}$	.82	41B24	B	$\frac{5}{8}$	$2\frac{1}{4}$	$3\frac{1}{4}$	1	2.33
25	4.260	A	41A25	$\frac{5}{8}$	.88	41B25	B	$\frac{5}{8}$	$2\frac{1}{4}$	$3\frac{1}{2}$	1	2.46
26	4.420	A	41A26	$\frac{5}{8}$	.94	41B26	B	$\frac{5}{8}$	$2\frac{1}{4}$	$3\frac{1}{4}$	1	2.50
27	4.580	A	41A27	$\frac{5}{8}$	1.00	41B27	B	$\frac{5}{8}$	$2\frac{1}{4}$	$3\frac{1}{4}$	1	2.56
28	4.740	A	41A28	$\frac{5}{8}$	1.08	41B28	B	$\frac{5}{8}$	$2\frac{1}{4}$	$3\frac{1}{4}$	1	2.64
30	5.060	A	41A30	$1\frac{1}{32}$	1.20	41B30	B	$\frac{5}{8}$	$2\frac{1}{4}$	$3\frac{1}{4}$	1	2.80
32	5.380	A	41A32	$1\frac{1}{32}$	1.44	41B32	B	$\frac{5}{8}$	$2\frac{1}{4}$	$3\frac{1}{4}$	1	2.96
35	5.860	A	41A35	$1\frac{1}{32}$	1.70	41B35	B	$\frac{5}{8}$	$2\frac{3}{8}$	$3\frac{1}{4}$	1	3.12
36	6.020	A	41A36	$1\frac{1}{32}$	1.84	41B36	B	$\frac{5}{8}$	$2\frac{3}{8}$	$3\frac{1}{4}$	1	3.32
40	6.650	A	41A40	$2\frac{1}{32}$	2.22	41B40	B	$\frac{3}{4}$	$2\frac{3}{8}$	$3\frac{1}{4}$	$1\frac{1}{16}$	4.06
42	6.970	A	41A42	$2\frac{1}{32}$	2.50	41B42	B	$\frac{3}{4}$	$2\frac{3}{8}$	$3\frac{1}{2}$	$1\frac{1}{16}$	4.10
45	7.450	A	41A45	$2\frac{1}{32}$	2.52	41B45	B	$\frac{3}{4}$	$2\frac{3}{8}$	$3\frac{1}{2}$	$1\frac{1}{16}$	4.18
48	7.930	A	41A48	$2\frac{1}{32}$	2.92	41B48	B	$\frac{3}{4}$	$2\frac{3}{8}$	$3\frac{1}{2}$	$1\frac{1}{16}$	4.92
54	8.890	A	41A54	$2\frac{1}{32}$	3.54	41B54	B	$\frac{3}{4}$	$2\frac{3}{8}$	$3\frac{1}{2}$	$1\frac{1}{16}$	5.68
60	9.840	A	41A60	$2\frac{1}{32}$	4.60	41B60	B	$\frac{3}{4}$	$2\frac{3}{8}$	$3\frac{1}{2}$	$1\frac{1}{16}$	6.78
70	11.430	A	41A70	$2\frac{1}{32}$	6.22	41B70	B	$\frac{3}{4}$	$2\frac{3}{8}$	4	$1\frac{1}{16}$	9.54
72	11.750	A	41A72	$2\frac{1}{32}$	6.32	41B72	B	$\frac{3}{4}$	$2\frac{3}{8}$	4	$1\frac{1}{16}$	9.64
80	13.030	A	41A80	$2\frac{1}{32}$	8.46	41B80	B	$\frac{3}{4}$	$2\frac{3}{8}$	4	$1\frac{1}{16}$	11.54
84	13.660	A	41A84	$2\frac{1}{32}$	9.12	41B84	B	$\frac{3}{4}$	$2\frac{3}{8}$	4	$1\frac{1}{16}$	12.20
96	15.570	A	41A96	$1\frac{1}{16}$	11.84	41B96	B	1	$2\frac{3}{8}$	4	$1\frac{1}{16}$	14.86
112	18.120	A	41A112	$1\frac{1}{16}$	15.84	41B112	B	1	$2\frac{3}{8}$	4	$1\frac{1}{16}$	19.16

# No.40-2 Stock Sprockets

- Pitch  $\frac{1}{2}$ "       Roller  $\Phi$  0.312"  
 Tooth width b1 0.275"       Tooth width B2 0.841"

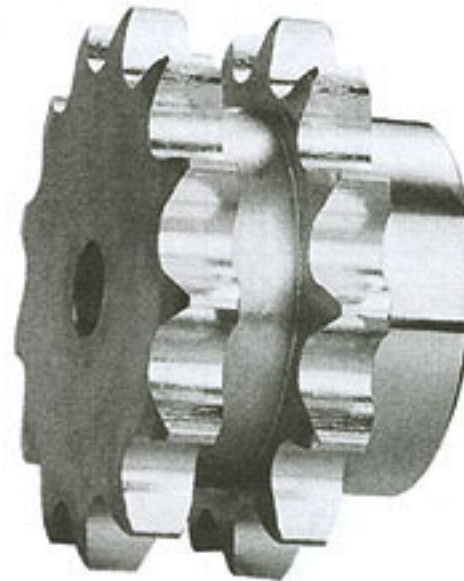
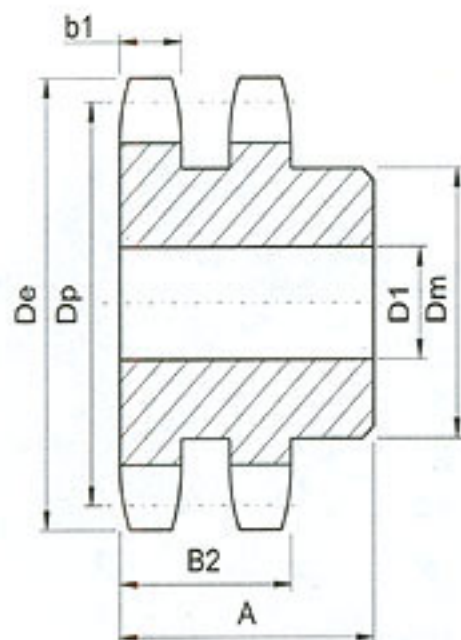

**TYPE B**

## Double-Type B

No. Teeth	SZS Number	De	Type	D1		Dm	A	Weight Lbs. (Approx.)
				Min.	Max.			
11	D40B11H	2.000	B	$\frac{1}{2}$	$\frac{3}{4}$	$1\frac{1}{2}\star$	$1\frac{1}{2}$	.62
12	D40B12H	2.170	B	$\frac{1}{2}$	$1\frac{1}{16}$	$1\frac{1}{2}\star$	$1\frac{1}{2}$	.76
13	D40B13H	2.330	B	$\frac{1}{2}$	1	$1\frac{1}{2}$	$1\frac{1}{2}$	.86
14	D40B14H	2.490	B	$\frac{1}{2}$	$1\frac{1}{8}$	$1\frac{1}{2}$	$1\frac{1}{2}$	1.08
15	D40B15H	2.650	B	$\frac{1}{2}$	$1\frac{1}{4}$	$1\frac{1}{2}$	$1\frac{1}{2}$	1.24
16	D40B16H	2.810	B	$\frac{5}{8}$	$1\frac{3}{8}$	2	$1\frac{1}{2}$	1.42
17	D40B17H	2.980	B	$\frac{5}{8}$	$1\frac{5}{8}$	$2\frac{1}{4}$	$1\frac{1}{2}$	1.64
18	D40B18H	3.140	B	$\frac{5}{8}$	$1\frac{7}{8}$	$2\frac{3}{8}$	$1\frac{1}{2}$	1.92
19	D40B19H	3.300	B	$\frac{5}{8}$	$1\frac{7}{8}$	$2\frac{1}{2}$	$1\frac{1}{2}$	2.22
20	D40B20H	3.460	B	$\frac{5}{8}$	$1\frac{7}{8}$	$2\frac{1}{2}$	$1\frac{1}{2}$	2.64
21	D40B21H	3.620	B	$\frac{5}{8}$	$1\frac{7}{8}$	$2\frac{1}{2}$	$1\frac{1}{2}$	2.94
22	D40B22H	3.780	B	$\frac{5}{8}$	$1\frac{7}{8}$	$2\frac{1}{2}$	$1\frac{1}{2}$	3.18
23	D40B23H	3.940	B	$\frac{5}{8}$	2	3	$1\frac{1}{2}$	3.51
24	D40B24H	4.100	B	$\frac{5}{8}$	$2\frac{1}{4}$	$3\frac{1}{4}$	$1\frac{1}{2}$	4.04
25	D40B25H	4.260	B	$\frac{5}{8}$	$2\frac{1}{4}$	$3\frac{1}{4}$	$1\frac{1}{2}$	4.26
26	D40B26	4.420	B	$\frac{5}{8}$	$2\frac{1}{4}$	$3\frac{1}{4}$	$1\frac{1}{2}$	4.48
30	D40B30	5.060	B	$\frac{7}{8}$	$2\frac{1}{2}$	$3\frac{3}{4}$	$1\frac{1}{2}$	5.34
35	D40B35	5.860	B	$\frac{7}{8}$	$2\frac{1}{2}$	$3\frac{3}{4}$	$1\frac{1}{2}$	6.80
36	D40B36	6.020	B	$1\frac{1}{16}$	$2\frac{1}{2}$	$3\frac{3}{4}$	$1\frac{1}{2}$	7.20
40	D40B40	6.650	B	$1\frac{1}{16}$	$2\frac{1}{2}$	$3\frac{3}{4}$	$1\frac{1}{2}$	9.40
42	D40B42	6.970	B	$1\frac{1}{16}$	$2\frac{1}{2}$	$3\frac{3}{4}$	$1\frac{1}{2}$	10.20
45	D40B45	7.450	B	$1\frac{1}{16}$	$2\frac{1}{2}$	$3\frac{3}{4}$	$1\frac{1}{2}$	11.36
48	D40B48	7.930	B	$1\frac{1}{16}$	$2\frac{1}{2}$	$3\frac{3}{4}$	$1\frac{1}{2}$	12.66
52	D40B52	8.570	B	$1\frac{1}{16}$	$2\frac{1}{2}$	$3\frac{3}{4}$	$1\frac{1}{2}$	14.46
54	D40B54	8.890	B	$1\frac{1}{16}$	$2\frac{1}{2}$	$3\frac{3}{4}$	$1\frac{1}{2}$	15.48
60	D40B60	9.840	B	$1\frac{1}{16}$	$2\frac{1}{2}$	$3\frac{3}{4}$	$1\frac{1}{2}$	18.60
68	D40B68	11.120	B	$1\frac{3}{16}$	$2\frac{1}{2}$	4	$2\frac{1}{2}$	24.96
72	D40B72	11.750	B	$1\frac{3}{16}$	$2\frac{1}{2}$	4	$2\frac{1}{2}$	27.88
76	D40B76	12.390	B	$1\frac{3}{16}$	$2\frac{1}{2}$	4	$2\frac{1}{2}$	30.18
84	D40B84	13.660	B	$1\frac{3}{16}$	$2\frac{1}{2}$	4	$2\frac{1}{2}$	36.24
95	D40B95	15.410	B	$1\frac{3}{16}$	$2\frac{1}{2}$	4	$2\frac{1}{2}$	38.84
96	D40B96	15.570	B	$1\frac{3}{16}$	$2\frac{1}{2}$	4	$2\frac{1}{2}$	39.50
102	D40B102	16.530	B	$1\frac{3}{16}$	$2\frac{1}{2}$	4	$2\frac{1}{2}$	42.72
112	D40B112	18.120	B	$1\frac{3}{16}$	$2\frac{1}{2}$	4	$2\frac{1}{2}$	55.54

# No.40-3

# Stock Sprockets

- Pitch  $\frac{1}{2}$ "
- Roller  $\Phi$  0.312"
- Tooth width b1 0.275"
- Tooth width B2 0.841"
- Tooth width B3 1.407"

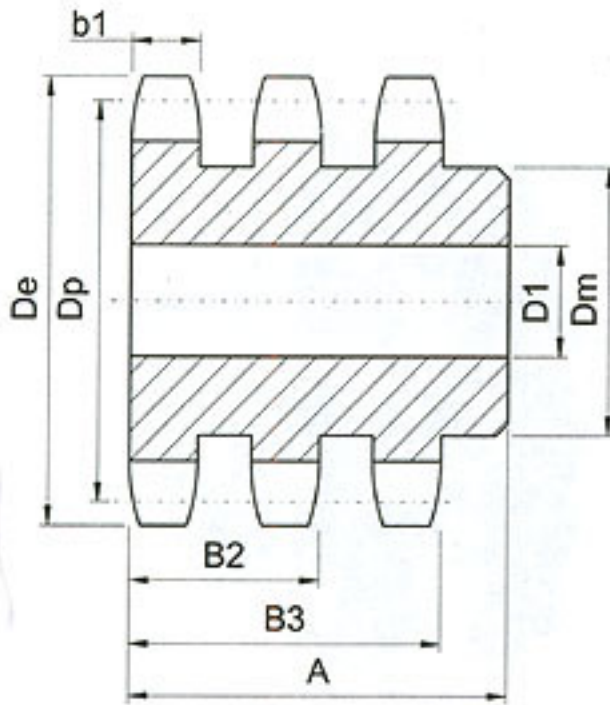

**TYPE B**

## Triple-Type B

No. Teeth	SZS Number	De	Type	D1		Dm	A	Weight Lbs. (Approx.)
				Min.	Max.			
11	E40B11H	2.000	B	$\frac{1}{2}$	$\frac{3}{4}$	$1\frac{1}{8}$ ★	$2\frac{1}{2}$	.80
12	E40B12H	2.170	B	$\frac{1}{2}$	$1\frac{1}{8}$	$1\frac{1}{8}$ ★	$2\frac{1}{2}$	1.10
13	E40B13H	2.330	B	$\frac{1}{2}$	1	$1\frac{1}{2}$	$2\frac{1}{2}$	1.24
14	E40B14H	2.490	B	$\frac{1}{2}$	$1\frac{1}{8}$	$1\frac{1}{8}$	$2\frac{1}{2}$	1.50
15	E40B15H	2.650	B	$\frac{1}{2}$	$1\frac{1}{4}$	$1\frac{1}{8}$	$2\frac{1}{2}$	1.76
16	E40B16H	2.810	B	$\frac{3}{8}$	$1\frac{1}{8}$	2	$2\frac{1}{2}$	2.04
17	E40B17H	2.980	B	$\frac{3}{8}$	$1\frac{1}{8}$	$2\frac{1}{2}$	$2\frac{1}{2}$	2.34
18	E40B18H	3.140	B	$\frac{3}{8}$	$1\frac{1}{2}$	$2\frac{1}{2}$	$2\frac{1}{2}$	2.72
19	E40B19H	3.300	B	$\frac{3}{8}$	1 $\frac{1}{4}$	$2\frac{1}{2}$	$2\frac{1}{2}$	3.10
20	E40B20H	3.460	B	$\frac{3}{8}$	$1\frac{1}{4}$	$2\frac{1}{2}$	$2\frac{1}{2}$	3.72
21	E40B21H	3.620	B	$\frac{3}{8}$	$1\frac{1}{4}$	$2\frac{1}{2}$	$2\frac{1}{2}$	4.06
22	E40B22H	3.780	B	$\frac{3}{8}$	$1\frac{1}{2}$	$2\frac{1}{2}$	$2\frac{1}{2}$	4.52
23	E40B23H	3.940	B	$\frac{3}{8}$	2	3	$2\frac{1}{2}$	4.96
24	E40B24H	4.100	B	$\frac{3}{8}$	$2\frac{1}{2}$	$3\frac{1}{4}$	$2\frac{1}{2}$	5.64
25	E40B25H	4.260	B	$\frac{3}{8}$	$2\frac{1}{2}$	$3\frac{1}{4}$	$2\frac{1}{2}$	6.02
26	E40B26	4.420	B	$\frac{3}{8}$	$2\frac{1}{2}$	$3\frac{1}{4}$	$2\frac{1}{2}$	6.36
30	E40B30	5.060	B	$\frac{3}{8}$	$2\frac{1}{2}$	$3\frac{1}{4}$	$2\frac{1}{2}$	7.84
35	E40B35	5.860	B	$\frac{3}{8}$	$2\frac{1}{2}$	$3\frac{1}{4}$	$2\frac{1}{2}$	10.30
36	E40B36	6.020	B	$1\frac{1}{8}$	$2\frac{1}{2}$	$3\frac{1}{4}$	$2\frac{1}{2}$	11.72
42	E40B42	6.970	B	$1\frac{1}{8}$	$2\frac{1}{2}$	$3\frac{1}{4}$	$2\frac{1}{2}$	15.36
48	E40B48	7.930	B	$1\frac{1}{8}$	$2\frac{1}{2}$	$3\frac{1}{4}$	$2\frac{1}{2}$	19.36
52	E40B52	8.570	B	$1\frac{1}{8}$	$2\frac{1}{2}$	$3\frac{1}{4}$	$2\frac{1}{2}$	22.44
60	E40B60	9.840	B	$1\frac{1}{8}$	$2\frac{1}{2}$	$3\frac{1}{4}$	$2\frac{1}{2}$	30.02
68	E40B68	11.120	B	$1\frac{3}{8}$	$2\frac{1}{2}$	4	$2\frac{1}{2}$	38.44
72	E40B72	11.750	B	$1\frac{3}{8}$	$2\frac{1}{2}$	4	$2\frac{1}{2}$	42.46
76	E40B76	12.390	B	$1\frac{3}{8}$	$2\frac{1}{2}$	4	$2\frac{1}{2}$	46.90
84	E40B84	13.660	B	$1\frac{3}{8}$	$2\frac{1}{2}$	$4\frac{1}{4}$	$2\frac{1}{2}$	57.30
95	E40B95	15.410	B	$1\frac{3}{8}$	$2\frac{1}{2}$	$4\frac{1}{4}$	$2\frac{1}{2}$	62.18
102	E40B102	16.530	B	$1\frac{3}{8}$	$2\frac{1}{2}$	$4\frac{1}{4}$	$2\frac{1}{2}$	68.40

# No.50

# Stock Sprockets

- Pitch  $\frac{5}{8}$ "  Roller  $\Phi$  0.400"
- Tooth width B1 0.343"

## Single-Type A

## Single-Type B

No. Teeth	De	Type	SZS Number	D1	Weight Lbs. (Approx.)	SZS Number	Type	D1		Dm	A	Weight Lbs. (Approx.)
								Min.	Max.			
8	1.880					50B8	B	$\frac{5}{16}$	$\frac{5}{16}$	$1\frac{1}{8}$ *	1	.25
9	2.090					50B9	B	$\frac{5}{16}$	$\frac{3}{8}$	$1\frac{1}{8}$ *	1	.36
10	2.300					50B10	B	$\frac{5}{16}$	$\frac{7}{16}$	$1\frac{1}{8}$ *	1	.48
11	2.500					50B11	B	$\frac{5}{16}$	1	$1\frac{1}{8}$ *	1	.64
12	2.710	A	50A12	$\frac{5}{8}$	.34	50B12	B	$\frac{5}{8}$	$1\frac{1}{4}$	$1\frac{1}{8}$ *	1	.83
13	2.910	A	50A13	$\frac{5}{8}$	.42	50B13	B	$\frac{5}{8}$	$1\frac{1}{8}$	$1\frac{1}{8}$ *	1	.88
14	3.110	A	50A14	$\frac{5}{8}$	.50	50B14	B	$\frac{5}{8}$	$1\frac{1}{8}$	$2\frac{1}{8}$	1	1.13
15	3.320	A	50A15	$\frac{5}{8}$	.54	50B15	B	$\frac{5}{8}$	$1\frac{1}{2}$	$2\frac{1}{8}$	1	1.34
16	3.520	A	50A16	$\frac{5}{8}$	.68	50B16	B	$\frac{5}{8}$	$1\frac{1}{4}$	$2\frac{1}{2}$	1	1.51
17	3.720	A	50A17	$\frac{5}{8}$	.76	50B17	B	$\frac{5}{8}$	$1\frac{1}{8}$	$2\frac{1}{8}$	1	1.74
18	3.920	A	50A18	$\frac{5}{8}$	.86	50B18	B	$\frac{5}{8}$	$1\frac{1}{8}$	$2\frac{3}{8}$	1	2.00
19	4.120	A	50A19	$\frac{5}{8}$	.94	50B19	B	$\frac{5}{8}$	2	3	1	2.22
20	4.320	A	50A20	$\frac{3}{4}$	1.06	50B20	B	$\frac{3}{4}$	2	3	1	2.28
21	4.520	A	50A21	$\frac{3}{4}$	1.12	50B21	B	$\frac{3}{4}$	2	3	1	2.40
22	4.720	A	50A22	$\frac{3}{4}$	1.30	50B22	B	$\frac{3}{4}$	2	3	1	2.56
23	4.920	A	50A23	$\frac{3}{4}$	1.44	50B23	B	$\frac{3}{4}$	2	3	1	2.66
24	5.120	A	50A24	$2\frac{1}{16}$	1.50	50B24	B	$\frac{3}{4}$	2	3	$1\frac{1}{4}$	3.30
25	5.320	A	50A25	$2\frac{1}{16}$	1.62	50B25	B	$\frac{3}{4}$	2	3	$1\frac{1}{4}$	3.40
26	5.520	A	50A26	$2\frac{1}{16}$	1.72	50B26	B	$\frac{3}{4}$	2	3	$1\frac{1}{4}$	3.44
27	5.720	A	50A27	$2\frac{1}{16}$	1.96	50B27	B	$\frac{3}{4}$	2	3	$1\frac{1}{4}$	3.74
28	5.920	A	50A28	$2\frac{1}{16}$	2.04	50B28	B	$\frac{3}{4}$	2	3	$1\frac{1}{4}$	3.80
29	6.120	A	50A29	$2\frac{1}{16}$	2.36	50B29	B	$\frac{3}{4}$	2	3	$1\frac{1}{4}$	4.06
30	6.320	A	50A30	$2\frac{1}{16}$	2.54	50B30	B	$\frac{3}{4}$	$2\frac{1}{4}$	$3\frac{1}{4}$	$1\frac{1}{4}$	4.56
31	6.520	A	50A31	$2\frac{1}{16}$	2.80	50B31	B	$\frac{3}{4}$	$2\frac{1}{4}$	$3\frac{1}{4}$	$1\frac{1}{4}$	4.74
32	6.720	A	50A32	$2\frac{1}{16}$	2.72	50B32	B	$\frac{3}{4}$	$2\frac{1}{4}$	$3\frac{1}{4}$	$1\frac{1}{4}$	4.96
33	6.920	A	50A33	$2\frac{1}{16}$	3.14	50B33	B	$\frac{3}{4}$	$2\frac{1}{4}$	$3\frac{1}{4}$	$1\frac{1}{4}$	5.20
34	7.120	A	50A34	$2\frac{1}{16}$	3.20	50B34	B	$\frac{3}{4}$	$2\frac{1}{4}$	$3\frac{1}{4}$	$1\frac{1}{4}$	5.14
35	7.320	A	50A35	$2\frac{1}{16}$	3.34	50B35	B	$\frac{3}{4}$	$2\frac{1}{4}$	$3\frac{1}{4}$	$1\frac{1}{4}$	5.44
36	7.520	A	50A36	$2\frac{1}{16}$	3.82	50B36	B	$\frac{3}{4}$	$2\frac{1}{4}$	$3\frac{1}{4}$	$1\frac{1}{4}$	5.64
37	7.720	A	50A37	$2\frac{1}{16}$	3.98	50B37	B	$\frac{3}{4}$	$2\frac{1}{4}$	$3\frac{1}{4}$	$1\frac{1}{4}$	5.90
38	7.920	A	50A38	$2\frac{1}{16}$	4.14	50B38	B	$\frac{3}{4}$	$2\frac{1}{4}$	$3\frac{1}{4}$	$1\frac{1}{4}$	6.08
39	8.120	A	50A39	$2\frac{1}{16}$	4.42	50B39	B	$\frac{3}{4}$	$2\frac{1}{4}$	$3\frac{1}{4}$	$1\frac{1}{4}$	6.30
40	8.320	A	50A40	$2\frac{1}{16}$	4.46	50B40	B	$\frac{3}{4}$	$2\frac{1}{4}$	$3\frac{1}{4}$	$1\frac{1}{4}$	6.50
41	8.520	A	50A41	$2\frac{1}{16}$	4.86	50B41	B	$\frac{3}{4}$	$2\frac{1}{4}$	$3\frac{1}{4}$	$1\frac{1}{4}$	6.64
42	8.720	A	50A42	$2\frac{1}{16}$	4.98	50B42	B	$\frac{3}{4}$	$2\frac{1}{4}$	$3\frac{1}{4}$	$1\frac{1}{4}$	6.96
43	8.910	A	50A43	$2\frac{1}{16}$	5.24	50B43	B	$\frac{3}{4}$	$2\frac{1}{4}$	$3\frac{1}{4}$	$1\frac{1}{4}$	7.06
44	9.110	A	50A44	$2\frac{1}{16}$	5.42	50B44	B	$\frac{3}{4}$	$2\frac{1}{4}$	$3\frac{1}{4}$	$1\frac{1}{4}$	7.58
45	9.310	A	50A45	$2\frac{1}{16}$	5.92	50B45	B	$\frac{3}{4}$	$2\frac{1}{2}$	$3\frac{1}{4}$	$1\frac{1}{4}$	8.58
46	9.510	A	50A46	$1\frac{1}{8}$	6.42	50B46	B	$\frac{3}{4}$	$2\frac{1}{2}$	$3\frac{3}{4}$	$1\frac{1}{4}$	8.22
47	9.710	A	50A47	$1\frac{1}{8}$	6.50	50B47	B	$\frac{3}{4}$	$2\frac{1}{2}$	$3\frac{3}{4}$	$1\frac{1}{4}$	8.48
48	9.910	A	50A48	$1\frac{1}{8}$	6.58	50B48	B	1	$2\frac{1}{2}$	$3\frac{3}{4}$	$1\frac{1}{4}$	9.28
49	10.110	A	50A49	$1\frac{1}{8}$	7.06	50B49	B	1	$2\frac{1}{2}$	$3\frac{3}{4}$	$1\frac{1}{4}$	9.22
50	10.310	A	50A50	$1\frac{1}{8}$	7.10	50B50	B	1	$2\frac{1}{2}$	$3\frac{3}{4}$	$1\frac{1}{4}$	9.88
51	10.510	A	50A51	$1\frac{1}{8}$	7.32	50B51	B	1	$2\frac{1}{2}$	$3\frac{3}{4}$	$1\frac{1}{4}$	9.70
52	10.710	A	50A52	$1\frac{1}{8}$	7.98	50B52	B	1	$2\frac{1}{2}$	$3\frac{3}{4}$	$1\frac{1}{4}$	10.24
53	10.910	A	50A53	$1\frac{1}{8}$	8.08	50B53	B	1	$2\frac{1}{2}$	$3\frac{3}{4}$	$1\frac{1}{4}$	10.48
54	11.110	A	50A54	$1\frac{1}{8}$	8.30	50B54	B	1	$2\frac{1}{2}$	$3\frac{3}{4}$	$1\frac{1}{4}$	11.00
55	11.310	A	50A55	$1\frac{1}{8}$	8.56	50B55	B	1	$2\frac{1}{2}$	$3\frac{3}{4}$	$1\frac{1}{4}$	10.93
56	11.500	A	50A56	$1\frac{1}{8}$	8.90	50B56	B	1	$2\frac{1}{2}$	$3\frac{3}{4}$	$1\frac{1}{4}$	11.50
57	11.700	A	50A57	$1\frac{1}{8}$	9.38	50B57	B	1	$2\frac{1}{2}$	$3\frac{3}{4}$	$1\frac{1}{4}$	12.00
58	11.900	A	50A58	$1\frac{1}{8}$	10.30	50B58	B	1	$2\frac{1}{2}$	$3\frac{3}{4}$	$1\frac{1}{4}$	11.82
59	12.100	A	50A59	$1\frac{1}{8}$	10.50	50B59	B	1	$2\frac{1}{2}$	$3\frac{3}{4}$	$1\frac{1}{4}$	12.32
60	12.300	A	50A60	$1\frac{1}{8}$	10.80	50B60	B	1	$2\frac{1}{2}$	$3\frac{3}{4}$	$1\frac{1}{4}$	13.00
70	14.290	A	50A70	$1\frac{1}{8}$	14.00	50B70	B	1	$2\frac{1}{2}$	$3\frac{3}{4}$	$1\frac{1}{4}$	18.16
72	14.690	A	50A72	$1\frac{1}{8}$	15.24	50B72	B	1	$2\frac{1}{2}$	$3\frac{3}{4}$	$1\frac{1}{4}$	19.48
76	15.486	A	50A76	$1\frac{1}{8}$	20.28	50B76	B	1	$2\frac{1}{2}$	$3\frac{3}{4}$	$1\frac{1}{4}$	21.00
80	16.280	A	50A80	$1\frac{1}{8}$	21.00	50B80	B	1	$2\frac{3}{4}$	$4\frac{1}{4}$	$1\frac{1}{4}$	24.74
84	17.080	A	50A84	$1\frac{1}{8}$	22.08	50B84	B	1	$2\frac{3}{4}$	$4\frac{1}{4}$	$1\frac{1}{4}$	25.50
95	19.270	A	50A95	$1\frac{1}{8}$	27.00	50B95	B	1	$2\frac{3}{4}$	$4\frac{1}{4}$	$1\frac{1}{4}$	32.00
96	19.470	A	50A96	$1\frac{1}{8}$	27.40	50B96	B	1	$2\frac{3}{4}$	$4\frac{1}{4}$	$1\frac{1}{4}$	32.92
112	22.650	A	50A112	$1\frac{1}{8}$	37.70	50B112	B	1	$2\frac{3}{4}$	$4\frac{1}{4}$	$1\frac{1}{4}$	42.00

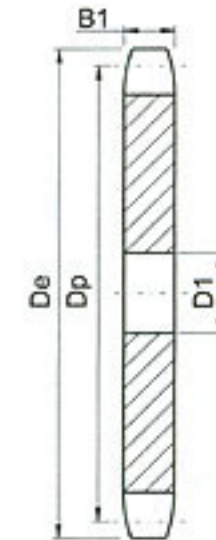

TYPE A

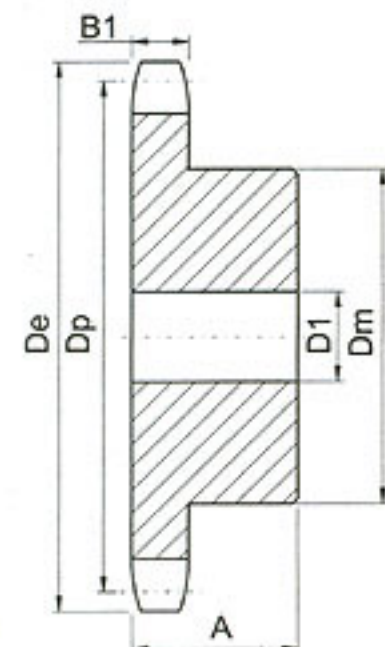

TYPE B





# No.50-2 Stock Sprockets

- Pitch  $\frac{5}{8}$ "       Roller  $\phi$  0.400"  
 Tooth width b1 0.332"       Tooth width B2 1.045"

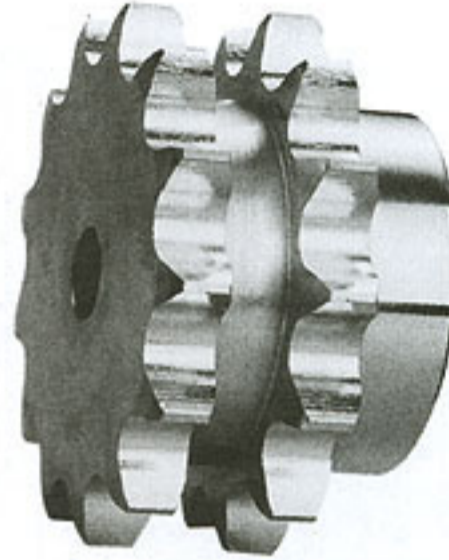
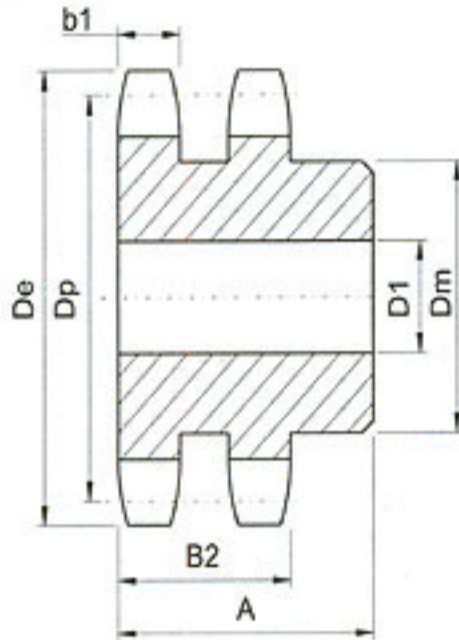

**TYPE B**  
**Double-Type B**

No. Teeth	SZS Number	De	Type	D1		Dm	A	Weight Lbs. (Approx.)
				Min.	Max.			
11	D50B11H	2.500	B	$\frac{5}{16}$	$\frac{15}{16}$	$1\frac{1}{32}$	$1\frac{1}{4}$	.96
12	D50B12H	2.710	B	$\frac{5}{16}$	$1\frac{1}{8}$	$1\frac{1}{16}$	$1\frac{1}{4}$	1.25
13	D50B13H	2.910	B	$\frac{5}{16}$	$1\frac{1}{8}$	$1\frac{1}{8}$	$1\frac{1}{4}$	1.56
14	D50B14H	3.110	B	$\frac{5}{16}$	$1\frac{1}{8}$	$2\frac{1}{16}$	$1\frac{1}{4}$	1.86
15	D50B15H	3.320	B	$\frac{3}{8}$	$1\frac{1}{2}$	$2\frac{1}{16}$	$1\frac{1}{4}$	2.22
16	D50B16H	3.520	B	$\frac{3}{8}$	$1\frac{1}{2}$	$2\frac{1}{2}$	$1\frac{1}{4}$	2.62
17	D50B17H	3.720	B	$\frac{3}{8}$	$1\frac{1}{2}$	$2\frac{3}{16}$	$1\frac{1}{4}$	3.04
18	D50B18H	3.920	B	$\frac{3}{8}$	$1\frac{7}{8}$	$2\frac{1}{2}$	$1\frac{1}{4}$	3.58
19	D50B19H	4.120	B	1	$2\frac{1}{4}$	$3\frac{3}{8}$	$1\frac{1}{4}$	3.90
20	D50B20H	4.320	B	1	$2\frac{1}{4}$	$3\frac{3}{8}$	$1\frac{1}{4}$	4.26
21	D50B21H	4.520	B	1	$2\frac{1}{4}$	$3\frac{3}{8}$	$1\frac{1}{4}$	4.90
22	D50B22H	4.720	B	1	$2\frac{1}{4}$	$3\frac{3}{8}$	$1\frac{1}{4}$	5.58
23	D50B23H	4.920	B	1	$2\frac{1}{2}$	$3\frac{3}{8}$	$1\frac{1}{4}$	6.10
24	D50B24H	5.120	B	1	$2\frac{1}{2}$	$3\frac{3}{8}$	$1\frac{1}{4}$	6.50
25	D50B25H	5.320	B	1	$2\frac{1}{2}$	$3\frac{3}{8}$	$1\frac{1}{4}$	6.94
26	D50B26	5.520	B	1	$2\frac{1}{2}$	$3\frac{3}{8}$	$1\frac{1}{4}$	7.54
30	D50B30	6.320	B	1	$2\frac{1}{2}$	$3\frac{3}{8}$	$1\frac{1}{4}$	9.40
32	D50B32	6.720	B	1	$2\frac{1}{2}$	$3\frac{3}{8}$	$1\frac{1}{4}$	10.46
35	D50B35	7.320	B	1	$2\frac{1}{2}$	$3\frac{3}{8}$	$1\frac{1}{4}$	12.28
36	D50B36	7.520	B	$1\frac{1}{16}$	$2\frac{1}{2}$	4	$2\frac{1}{4}$	13.94
40	D50B40	8.320	B	$1\frac{1}{16}$	$2\frac{1}{2}$	4	$2\frac{1}{4}$	16.54
42	D50B42	8.720	B	$1\frac{1}{16}$	$2\frac{1}{2}$	4	$2\frac{1}{4}$	17.92
45	D50B45	9.310	B	$1\frac{1}{16}$	$2\frac{1}{2}$	4	$2\frac{1}{4}$	20.30
48	D50B48	9.910	B	$1\frac{1}{16}$	$2\frac{1}{2}$	$4\frac{1}{4}$	$2\frac{1}{4}$	24.08
52	D50B52	10.710	B	$1\frac{1}{16}$	$2\frac{1}{2}$	$4\frac{1}{4}$	$2\frac{1}{4}$	27.42
54	D50B54	11.110	B	$1\frac{1}{16}$	$2\frac{1}{2}$	$4\frac{1}{4}$	$2\frac{1}{4}$	29.16
60	D50B60	12.300	B	$1\frac{1}{16}$	3	$4\frac{1}{2}$	$2\frac{1}{4}$	35.88
68	D50B68	13.890	B	$1\frac{1}{16}$	3	$4\frac{1}{2}$	$2\frac{1}{4}$	44.98
72	D50B72	14.690	B	$1\frac{1}{16}$	3	$4\frac{1}{2}$	$2\frac{1}{4}$	50.22
76	D50B76	15.490	B	$1\frac{1}{16}$	3	$4\frac{1}{2}$	$2\frac{1}{4}$	45.64
84	D50B84	17.080	B	$1\frac{1}{16}$	3	$4\frac{1}{2}$	$2\frac{1}{4}$	51.64
95	D50B95	19.270	B	$1\frac{1}{16}$	3	$4\frac{1}{2}$	$2\frac{1}{4}$	64.32
96	D50B96	19.470	B	$1\frac{1}{16}$	3	$4\frac{1}{2}$	$2\frac{1}{4}$	67.42
102	D50B102	20.660	B	$1\frac{1}{16}$	3	$4\frac{1}{2}$	$2\frac{1}{4}$	72.68
112	D50B112	22.650	B	$1\frac{1}{16}$	$3\frac{1}{16}$	5	$2\frac{1}{4}$	90.22

# No.50-3 Stock Sprockets

- Pitch  $\frac{5}{8}$ "       Roller  $\Phi$  0.400"  
 Tooth width b1 0.332"       Tooth width B2 1.045"       Tooth width B3 1.758"

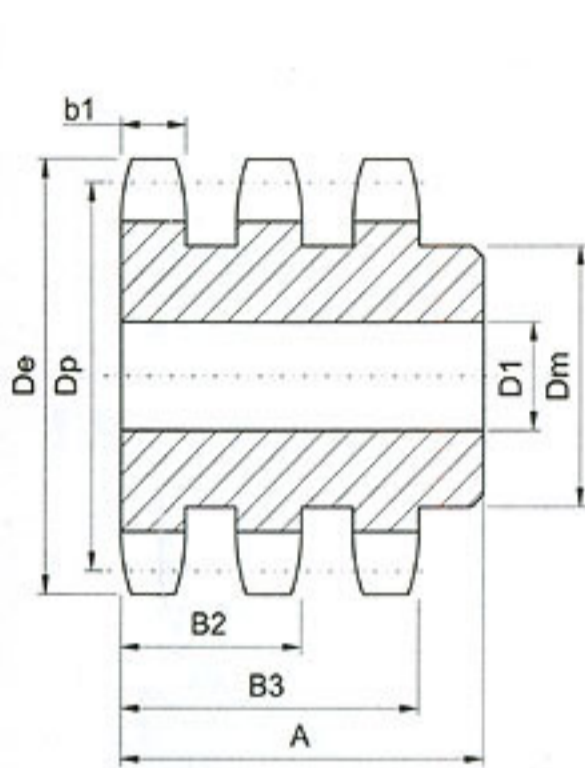

TYPE B

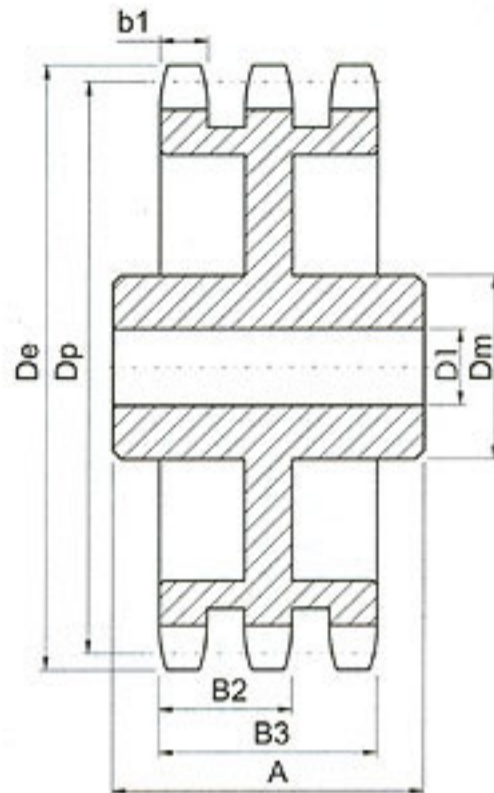

TYPE C



## Triple-Type B & C

No. Teeth	SZS Number	De	Type	D1		Dm	A	Weight Lbs. (Approx.)
				Min.	Max.			
11	E50B11H	2.500	B	$\frac{5}{16}$	$\frac{1}{8}$	$1\frac{1}{2}$	$2\frac{1}{2}$	1.42
12	E50B12H	2.710	B	$\frac{5}{16}$	$1\frac{1}{16}$	$1\frac{1}{8}$	$2\frac{1}{2}$	1.84
13	E50B13H	2.910	B	$\frac{5}{16}$	$1\frac{1}{16}$	$1\frac{1}{8}$	$2\frac{1}{2}$	2.28
14	E50B14H	3.110	B	$\frac{5}{16}$	$1\frac{1}{8}$	$2\frac{1}{16}$	$2\frac{1}{2}$	2.72
15	E50B15H	3.320	B	$\frac{3}{8}$	$1\frac{1}{2}$	$2\frac{3}{16}$	$2\frac{1}{2}$	3.24
16	E50B16H	3.520	B	$\frac{3}{8}$	$1\frac{1}{8}$	$2\frac{1}{8}$	$2\frac{1}{2}$	3.76
17	E50B17H	3.720	B	$\frac{3}{8}$	$1\frac{1}{8}$	$2\frac{3}{16}$	$2\frac{1}{2}$	4.38
18	E50B18H	3.920	B	$\frac{3}{8}$	$1\frac{1}{8}$	$2\frac{3}{16}$	$2\frac{1}{2}$	5.10
19	E50B19H	4.120	B	1	$2\frac{1}{8}$	$3\frac{1}{8}$	$2\frac{1}{2}$	5.60
20	E50B20H	4.320	B	1	$2\frac{1}{4}$	$3\frac{1}{4}$	$2\frac{1}{2}$	6.42
21	E50B21H	4.520	B	1	$2\frac{1}{2}$	$3\frac{1}{2}$	$2\frac{1}{2}$	7.42
22	E50B22H	4.720	B	1	$2\frac{1}{2}$	$3\frac{3}{8}$	$2\frac{1}{2}$	7.92
23	E50B23H	4.920	B	1	$2\frac{1}{2}$	$3\frac{3}{8}$	$2\frac{1}{2}$	8.80
24	E50B24H	5.120	B	1	$2\frac{1}{2}$	$3\frac{3}{8}$	$2\frac{1}{2}$	9.42
25	E50B25H	5.320	B	1	$2\frac{1}{2}$	$3\frac{3}{8}$	$2\frac{1}{2}$	10.16
26	E50B26	5.520	B	1	$2\frac{1}{2}$	$3\frac{3}{8}$	$2\frac{1}{2}$	11.02
30	E50B30	6.320	B	1	$2\frac{1}{2}$	$3\frac{3}{8}$	$2\frac{1}{2}$	14.24
35	E50B35	7.320	B	1	$2\frac{1}{2}$	$3\frac{3}{8}$	$2\frac{1}{2}$	18.96
36	E50B36	7.520	B	$1\frac{1}{16}$	$2\frac{1}{2}$	4	$2\frac{1}{2}$	20.60
42	E50B42	8.720	B	$1\frac{1}{16}$	$2\frac{1}{2}$	4	$2\frac{1}{2}$	27.46
48	E50B48	9.910	B	$1\frac{1}{16}$	$2\frac{1}{2}$	4	$3\frac{1}{8}$	36.64
52	E50B52	10.710	B	$1\frac{1}{16}$	$2\frac{1}{2}$	4	$3\frac{1}{8}$	42.54
60	E50B60	12.300	B	$1\frac{1}{16}$	3	$4\frac{1}{2}$	$3\frac{1}{8}$	56.84
68	E50B68	13.890	B	$1\frac{1}{16}$	3	$4\frac{1}{2}$	$3\frac{1}{8}$	73.21
72	E50C72	14.690	C	$1\frac{1}{16}$	3	$4\frac{1}{2}$	$3\frac{1}{2}$	54.40
76	E50C76	15.490	C	$1\frac{1}{16}$	3	$4\frac{1}{2}$	$3\frac{1}{2}$	51.20
84	E50C84	17.080	C	$1\frac{1}{16}$	3	$4\frac{1}{2}$	$3\frac{1}{2}$	65.32
95	E50C95	19.270	C	$1\frac{1}{16}$	3	$4\frac{1}{2}$	$3\frac{1}{2}$	74.42
102	E50C102	20.660	C	$1\frac{1}{16}$	3	$4\frac{1}{2}$	$3\frac{1}{2}$	79.94



# No.60-2 Stock Sprockets

- Pitch  $\frac{3}{4}$ "       Roller  $\Phi$  0.468"  
 Tooth width b1 0.444"       Tooth width B2 1.341"

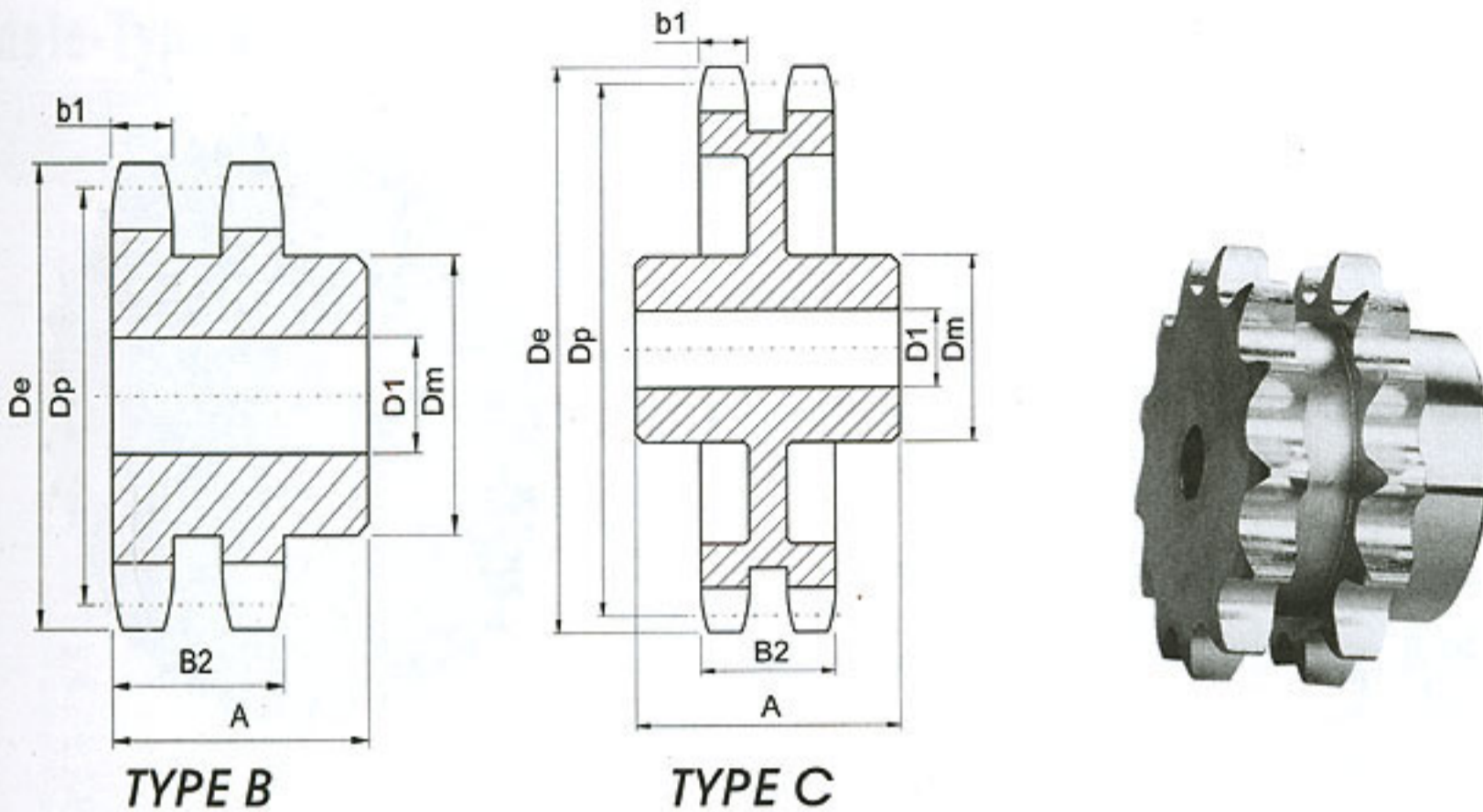

## Double-Type B & C

No. Teeth	SZS Number	De	Type	D1		Dm	A	Weight Lbs. (Approx.)
				Min.	Max.			
11	D60B11H	3.000	B	1	1 $\frac{1}{4}$	1 $\frac{1}{2}$	2 $\frac{1}{2}$	1.62
12	D60B12H	3.250	B	1	1 $\frac{1}{2}$	2 $\frac{1}{2}$	2 $\frac{1}{2}$	2.20
13	D60B13H	3.490	B	1	1 $\frac{1}{2}$	2 $\frac{1}{2}$	2 $\frac{1}{2}$	2.60
14	D60B14H	3.740	B	1	1 $\frac{1}{2}$	2 $\frac{1}{2}$	2 $\frac{1}{2}$	3.24
15	D60B15H	3.980	B	1	1 $\frac{1}{2}$	2 $\frac{1}{2}$	2 $\frac{1}{2}$	3.96
16	D60B16H	4.220	B	1	2	3	2 $\frac{1}{2}$	4.62
17	D60B17H	4.460	B	1	2 $\frac{1}{4}$	3 $\frac{1}{2}$	2 $\frac{1}{2}$	5.40
18	D60B18H	4.700	B	1	2 $\frac{1}{2}$	3 $\frac{1}{2}$	2 $\frac{1}{2}$	6.24
19	D60B19H	4.950	B	1	2 $\frac{1}{2}$	3 $\frac{1}{2}$	2 $\frac{1}{2}$	7.00
20	D60B20H	5.190	B	1	2 $\frac{1}{2}$	3 $\frac{1}{2}$	2 $\frac{1}{2}$	7.72
21	D60B21H	5.430	B	1	2 $\frac{1}{2}$	4 $\frac{1}{2}$	2 $\frac{1}{2}$	8.82
22	D60B22H	5.670	B	1	2 $\frac{1}{2}$	4 $\frac{1}{2}$	2 $\frac{1}{2}$	9.68
23	D60B23H	5.910	B	1	2 $\frac{1}{2}$	4 $\frac{1}{2}$	2 $\frac{1}{2}$	10.30
24	D60B24H	6.150	B	1	2 $\frac{1}{2}$	4 $\frac{1}{2}$	2 $\frac{1}{2}$	11.14
25	D60B25H	6.390	B	1	2 $\frac{1}{2}$	4 $\frac{1}{2}$	2 $\frac{1}{2}$	11.96
26	D60B26	6.630	B	1	2 $\frac{1}{2}$	4 $\frac{1}{2}$	2 $\frac{1}{2}$	12.70
30	D60B30	7.590	B	1	2 $\frac{1}{2}$	4 $\frac{1}{2}$	2 $\frac{1}{2}$	16.36
32	D60B32	8.070	B	1 $\frac{1}{2}$	3	4 $\frac{1}{2}$	2 $\frac{1}{2}$	19.52
35	D60B35	8.780	B	1 $\frac{1}{2}$	3	4 $\frac{1}{2}$	2 $\frac{1}{2}$	22.80
36	D60B36	9.020	B	1 $\frac{1}{2}$	3	4 $\frac{1}{2}$	2 $\frac{1}{2}$	23.82
40	D60B40	9.980	B	1 $\frac{1}{2}$	3 $\frac{1}{2}$	4 $\frac{1}{2}$	2 $\frac{1}{2}$	30.84
42	D60B42	10.460	B	1 $\frac{1}{2}$	3 $\frac{1}{2}$	4 $\frac{1}{2}$	2 $\frac{1}{2}$	33.08
45	D60B45	11.180	B	1 $\frac{1}{2}$	3 $\frac{1}{2}$	4 $\frac{1}{2}$	2 $\frac{1}{2}$	37.08
52	D60B52	12.850	B	1 $\frac{1}{2}$	3 $\frac{1}{2}$	4 $\frac{1}{2}$	2 $\frac{1}{2}$	48.70
60	D60B60	14.760	B	1 $\frac{1}{2}$	3 $\frac{1}{2}$	4 $\frac{1}{2}$	2 $\frac{1}{2}$	63.10
68	D60C68	16.670	C	1 $\frac{1}{2}$	3 $\frac{1}{2}$	5	3	53.68
72	D60C72	17.630	C	1 $\frac{1}{2}$	3 $\frac{1}{2}$	5	3	53.74
76	D60C76	18.580	C	1 $\frac{1}{2}$	3 $\frac{1}{2}$	5	3	60.28
95	D60C95	23.120	C	1 $\frac{1}{2}$	3 $\frac{1}{2}$	5 $\frac{1}{2}$	3 $\frac{1}{2}$	87.14

# No.60-3 Stock Sprockets

- Pitch  $\frac{3}{4}$ "       Roller  $\phi$  0.468"  
 Tooth width b1 0.444"       Tooth width B2 1.341"       Tooth width B3 2.238"

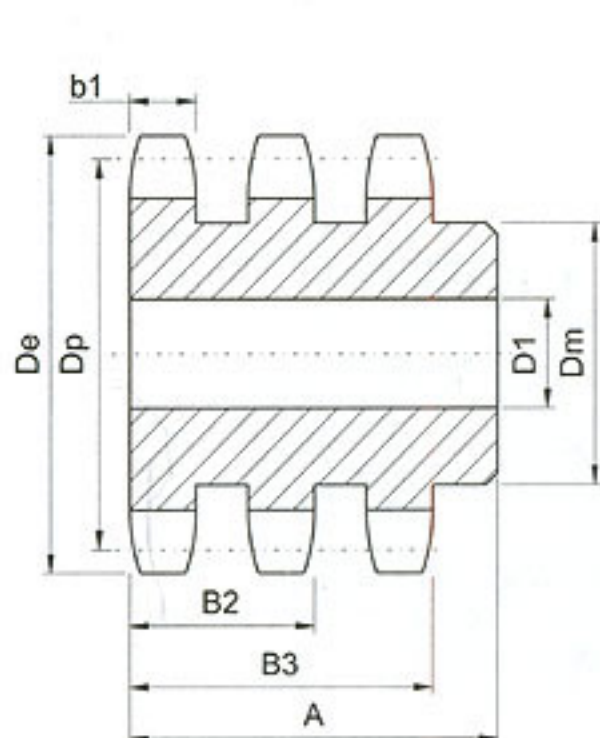

**TYPE B**

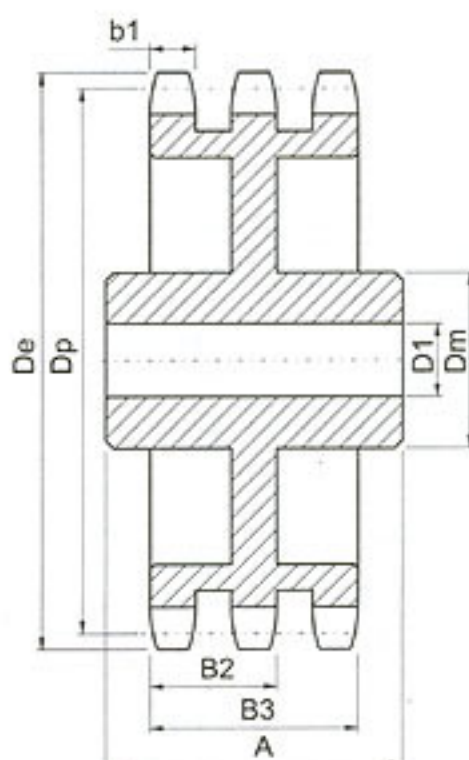

**TYPE C**



## Triple-Type B & C

No. Teeth	SZS Number	De	Type	D1		Dm	A	Weight Lbs. (Approx.)
				Min.	Max.			
11	E60B11H	3.000	B	1	1 1/4	1 1/4	3	2.5
12	E60B12H	3.250	B	1	1 1/2	2 1/4	3	3.3
13	E60B13H	3.490	B	1	1 1/2	2 1/4	3	3.9
14	E60B14H	3.740	B	1	1 1/2	2 1/2	3	4.5
15	E60B15H	3.980	B	1	1 1/2	2 1/2	3	5.4
16	E60B16H	4.220	B	1	2	3	3	6.5
17	E60B17H	4.460	B	1	2 1/4	3 1/2	3	7.7
18	E60B18H	4.700	B	1	2 1/4	3 1/2	3	8.5
19	E60B19H	4.950	B	1	2 1/2	3 1/2	3	10.0
20	E60B20H	5.190	B	1	2 1/2	3 3/4	3	11.2
21	E60B21H	5.430	B	1	2 1/2	4	3	12.5
22	E60B22H	5.670	B	1	2 1/2	4 1/4	3	13.2
23	E60B23H	5.910	B	1	2 1/2	4 1/4	3	14.6
24	E60B24H	6.150	B	1	2 1/2	4 1/2	3	15.8
25	E60B25H	6.390	B	1	2 1/2	4 1/2	3	17.0
26	E60B26	6.630	B	1	2 1/2	4 1/2	3	18.6
30	E60B30	7.590	B	1	2 1/2	4 1/2	3	23.2
35	E60B35	8.780	B	1 1/4	3	4 1/2	3 1/4	34.5
36	E60B36	9.020	B	1 1/4	3	4 1/2	3 1/4	37.0
42	E60B42	10.460	B	1 1/4	3 1/4	4 1/2	3 1/4	49.0
45	E60B45	11.180	B	1 1/4	3 1/4	4 1/2	3 1/4	57.0
52	E60C52	12.850	C	1 1/4	3 1/4	4 1/2	3 1/2	73.0
60	E60C60	14.760	C	1 1/4	3 1/4	4 1/2	3 1/2	63.0
68	E60C68	16.670	C	1 1/4	3 1/4	5	3 1/2	73.0
72	E60C72	17.630	C	1 1/4	3 1/4	5	3 1/2	85.0
76	E60C76	18.580	C	1 1/2	3 1/4	5 1/2	3 1/2	82.0
95	E60C95	23.120	C	1 1/2	3 1/4	5 1/2	4	105.0

- Pitch 1"       Roller  $\Phi$  0.625"  
 Tooth width B1 0.575"

## Single-Type A

## Single-Type B & C

No. Teeth	De	Type	SZS Number	D1	Weight Lbs. (Approx.)	SZS Number	Type	D1		Dm	A	Weight Lbs. (Approx.)
								Min.	Max.			
8	3.010					80B8	B	1	1	1 1/16★	1 1/2	1.4
9	3.350	A	80A9	1 1/16	.8	80B9	B	1	1 1/16	2 1/4★	1 1/2	1.6
10	3.680	A	80A10	1 1/16	1.0	80B10	B	1	1 1/2	2 3/8★	1 1/2	2.2
11	4.010	A	80A11	1 1/16	1.3	80B11	B	1	1 3/4	2 1/2★	1 1/2	3.2
12	4.330	A	80A12	1 1/16	1.5	80B12	B	1	1 3/4	3 1/8★	1 1/2	3.4
13	4.660	A	80A13	1 1/8	1.8	80B13	B	1	2	3	1 1/2	3.5
14	4.980	A	80A14	1 1/8	2.2	80B14	B	1	2 1/4	3 1/4	1 1/2	4.1
15	5.300	A	80A15	1 1/8	2.5	80B15	B	1	2 1/2	3 3/8	1 1/2	5.3
16	5.630	A	80A16	1 1/8	2.9	80B16	B	1	2 3/4	4	1 1/2	5.9
17	5.950	A	80A17	1 1/8	3.3	80B17	B	1	2 3/4	4	1 1/2	6.6
18	6.270	A	80A18	1 1/8	3.7	80B18	B	1	2 3/4	4 1/4	1 1/2	7.3
19	6.590	A	80A19	1 1/8	4.1	80B19	B	1	2 3/4	4 1/4	1 1/2	7.8
20	6.910	A	80A20	1 1/8	4.7	80B20	B	1	2 3/4	4 1/4	1 1/2	8.4
21	7.240	A	80A21	1 1/8	4.9	80B21	B	1	2 3/4	4 1/4	1 1/2	9.4
22	7.560	A	80A22	1 1/8	5.5	80B22	B	1	2 3/4	4 1/4	1 1/2	10.0
23	7.880	A	80A23	1 1/8	6.3	80B23	B	1	2 3/4	4 1/4	1 1/2	10.7
24	8.200	A	80A24	1 1/8	6.7	80B24	B	1	2 3/4	4 1/4	1 1/2	11.3
25	8.520	A	80A25	1 1/8	7.2	80B25	B	1	2 3/4	4 1/4	1 1/2	11.9
26	8.840	A	80A26	1 1/8	7.8	80B26	B	1 1/4	3 1/4	4 1/4	2	14.3
27	9.160	A	80A27	1 1/8	8.6	80B27	B	1 1/4	3 1/4	4 1/4	2	15.4
28	9.480	A	80A28	1 1/8	9.3	80B28	B	1 1/4	3 1/4	4 1/4	2	16.0
29	9.800	A	80A29	1 1/8	9.8	80B29	B	1 1/8	3 1/4	4 1/4	2	17.1
30	10.110	A	80A30	1 1/8	10.7	80B30	B	1 1/8	3 1/4	4 1/4	2	17.4
31	10.430	A	80A31	1 1/8	11.3	80B31	B	1 1/8	3 1/4	4 1/4	2	18.7
32	10.750	A	80A32	1 1/8	12.1	80B32	B	1 1/8	3 1/4	4 1/4	2	19.5
33	11.070	A	80A33	1 1/8	13.6	80B33	B	1 1/8	3 1/4	4 1/4	2	19.6
34	11.390	A	80A34	1 1/8	14.3	80B34	B	1 1/8	3 1/4	4 1/4	2	21.3
35	11.710	A	80A35	1 1/8	14.8	80B35	B	1 1/8	3 1/4	4 1/4	2	22.1
36	12.030	A	80A36	1 1/8	16.1	80B36	B	1 1/8	3 1/4	4 1/4	2	23.1
37	12.350	A	80A37	1 1/8	16.8	80B37	B	1 1/8	3 1/4	4 1/4	2	23.8
38	12.670	A	80A38	1 1/8	17.2	80B38	B	1 1/8	3 1/4	4 1/4	2	24.7
39	12.990	A	80A39	1 1/8	17.9	80B39	B	1 1/8	3 1/4	4 1/4	2	25.6
40	13.310	A	80A40	1 1/8	18.9	80B40	B	1 1/8	3 1/4	4 1/4	2	26.7
41	13.630	A	80A41	1 1/4	21.0	80B41	B	1 1/4	3 1/4	4 1/4	2	27.8
42	13.940	A	80A42	1 1/4	21.8	80B42	B	1 1/4	3 1/4	4 1/4	2	28.7
43	14.260	A	80A43	1 1/4	23.6	80B43	B	1 1/4	3 1/4	4 1/4	2	29.4
44	14.580	A	80A44	1 1/4	24.3	80B44	B	1 1/4	3 1/4	4 1/4	2	29.9
45	14.900	A	80A45	1 1/4	25.2	80B45	B	1 1/4	3 1/4	4 1/4	2	31.4
46	15.220	A	80A46	1 1/4	26.6	80B46	B	1 1/4	3 1/4	4 1/4	2	33.1
47	15.540	A	80A47	1 1/4	26.4	80B47	B	1 1/4	3 1/4	4 1/4	2	34.0
48	15.860	A	80A48	1 1/4	27.8	80B48	B	1 1/4	3 1/4	4 1/4	2	35.5
49	16.180	A	80A49	1 1/4	28.9	80B49	B	1 1/4	3 1/4	4 1/4	2	35.8
50	16.500	A	80A80	1 1/4	30.9	80B50	B	1 1/4	3 1/4	4 1/4	2	37.3
51	16.810	A	80A51	1 1/4	32.2	80B51	B	1 1/4	3 1/4	4 1/4	2	38.6
52	17.130	A	80A52	1 1/4	33.0	80B52	B	1 1/4	3 1/4	4 1/4	2	39.4
53	17.450	A	80A53	1 1/4	34.9	80B53	B	1 1/4	3 1/4	4 1/4	2	41.3
54	17.770	A	80A54	1 1/4	36.6	80B54	B	1 1/4	3 1/2	5 1/4	2	44.7
55	18.090	A	80A55	1 1/4	37.5	80B55	B	1 1/4	3 1/2	5 1/4	2	45.6
56	18.410	A	80A56	1 1/4	39.4	80B56	B	1 1/4	3 1/2	5 1/4	2	47.5
57	18.730	A	80A57	1 1/4	40.4	80B57	B	1 1/4	3 1/2	5 1/4	2	48.5
58	19.040	A	80A58	1 1/4	41.3	80B58	B	1 1/4	3 1/2	5 1/4	2	50.5
59	19.360	A	80A59	1 1/4	42.9	80B59	B	1 1/4	3 1/2	5 1/4	2	52.1
60	19.680	A	80A60	1 1/4	45.3	80B60	B	1 1/4	3 1/2	5 1/4	2	54.5
65	21.270	A	80A65	1 1/4	52.2	80B65	B	1 1/4	3 1/2	5 1/4	2	61.8
70	22.870	A	80A70	1 1/2	59.8	80C70	C	1 1/2	4 1/4	6 1/4	3 1/2	75.7
72	23.500	A	80A72	1 1/2	65.7	80C72	C	1 1/2	4 1/4	6 1/4	3 1/2	81.4
76	24.780	A	80A76	1 1/2	70.2	80C76	C	1 1/2	4 1/4	6 1/4	3 1/2	87.8
80	26.050	A	80A80	1 1/2	79.6	80C80	C	1 1/2	4 1/4	6 1/4	3 1/2	89.9
84	27.330	A	80A84	1 1/2	86.1	80C84	C	1 1/2	4 1/4	6 1/4	3 1/2	99.2
90	29.240	A	80A90	1 1/2	101	80C90	C	1 1/2	4 1/4	6 1/4	3 1/2	106
96	31.150	A	80A96	1 1/2	120	80C96	C	1 1/2	4 1/4	6 1/4	3 1/2	117
112	36.240	A	80A112	1 1/2	165	80C112	C	1 1/2	4 1/4	6 1/4	3 1/2	154

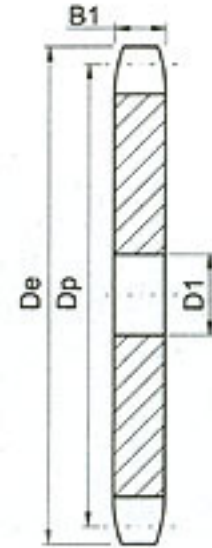

TYPE A

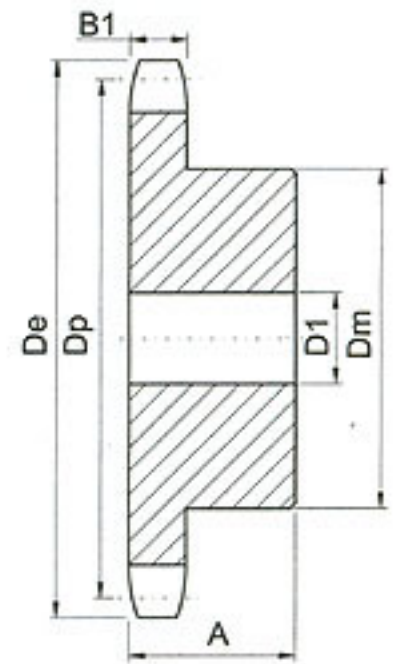

TYPE B

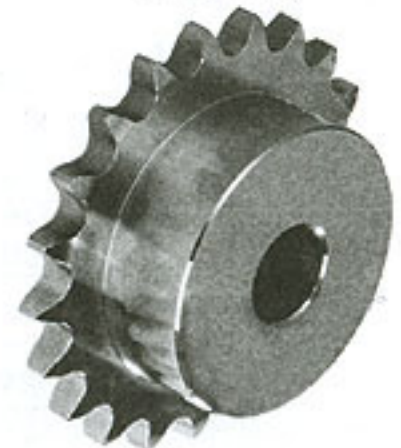

# No.80-2 Stock Sprockets

- Pitch 1"       Roller  $\Phi$  0.625"  
 Tooth width b1 0.557"       Tooth width B2 1.710"

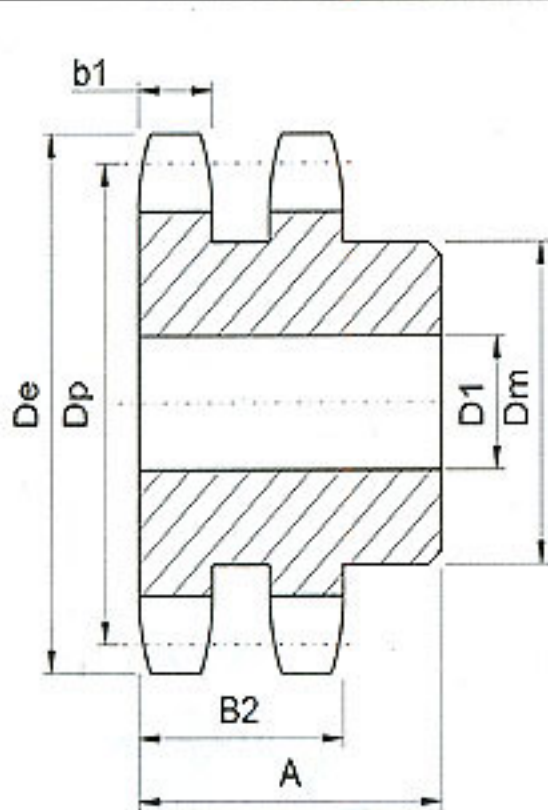

TYPE B

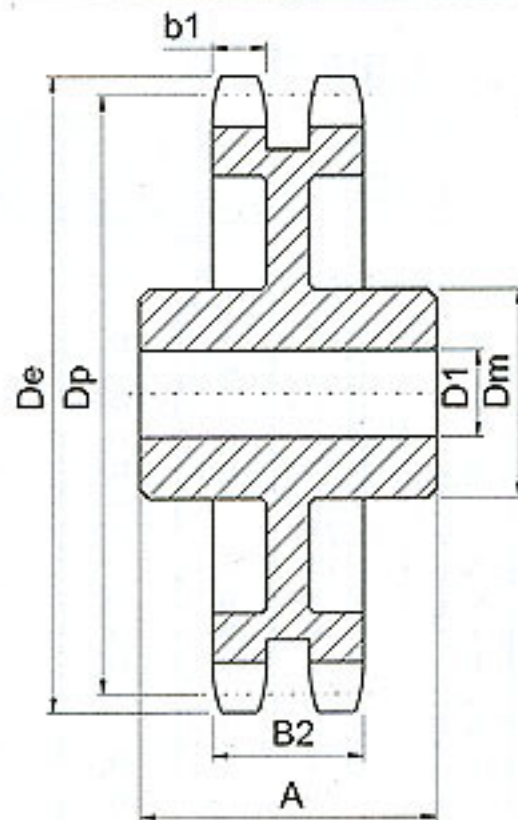

TYPE C

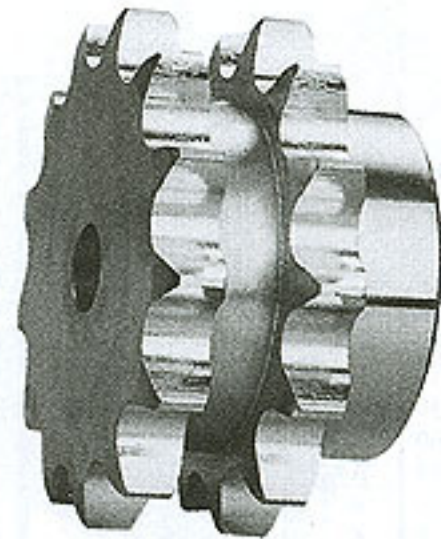

## Double-Type B & C

No. Teeth	SZS Number	De	Type	D1		Dm	A	Weight Lbs. (Approx.)
				Min.	Max.			
10	D80B10H	3.680	B	1	1½	2¼*	2¼	3.6
11	D80B11H	4.010	B	1	1¾	2½	2½	4.0
12	D80B12H	4.330	B	1	1¾	2¾	2½	5.1
13	D80B13H	4.660	B	1	2¼	3½	2½	6.3
14	D80B14H	4.980	B	1	2¾	3¾	2½	7.6
15	D80B15H	5.300	B	1	2¾	3¾	2½	9.0
16	D80B16H	5.630	B	1	2¾	4	2½	11.0
17	D80B17H	5.950	B	1	3	4¼	2½	13.2
18	D80B18H	6.270	B	1	3¼	4¼	2½	15.0
19	D80B19H	6.590	B	1	3½	5	2½	17.0
20	D80B20H	6.910	B	1	3½	5	2½	18.2
21	D80B21H	7.240	B	1	3½	5	2½	19.6
22	D80B22H	7.560	B	1	3½	5	2½	21.0
23	D80B23H	7.880	B	1	3½	5	2½	22.8
24	D80B24H	8.200	B	1	3½	5¼	2½	25.1
25	D80B25H	8.520	B	1	3½	5¼	3	28.3
26	D80B26	8.840	B	1	3½	5¼	3	29.9
30	D80B30	10.110	B	1½	3¾	5¾	3	39.5
32	D80B32	10.750	B	1½	3¾	5¾	3	43.8
35	D80B35	11.710	B	1½	3¾	5¾	3	49.1
36	D80B36	12.030	B	1½	3¾	5¾	3¾	54.2
42	D80B42	13.940	B	1½	3¾	5¾	3¾	71.5
45	D80B45	14.900	B	1½	3¾	5¾	3¾	73.5
52	D80C52	17.130	C	1½	3¾	5¾	3¾	78.4
60	D80C60	19.680	C	1½	3¾	5¾	3¾	93.3
68	D80C68	22.230	C	1½	3¾	6	4	96.2
76	D80C76	24.780	C	1½	3¾	6	4	113
95	D80C95	30.830	C	1½	4	6	4¼	165

# No.80-3 Stock Sprockets

- Pitch 1"       Roller  $\Phi$  0.625"  
 Tooth width b1 0.557"       Tooth width B2 1.710"       Tooth width B3 2.863"

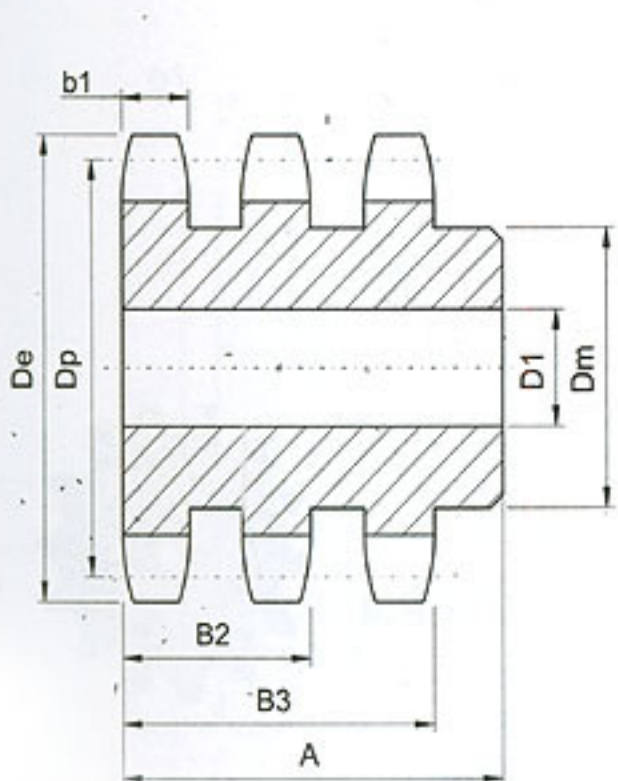

TYPE B

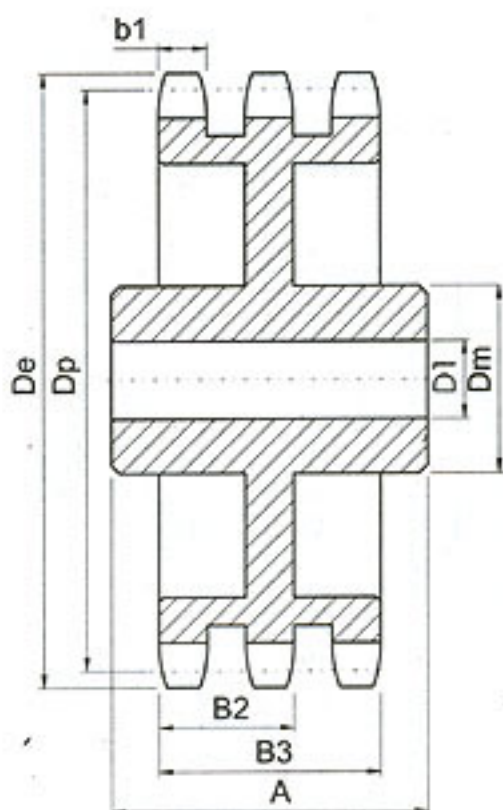

TYPE C

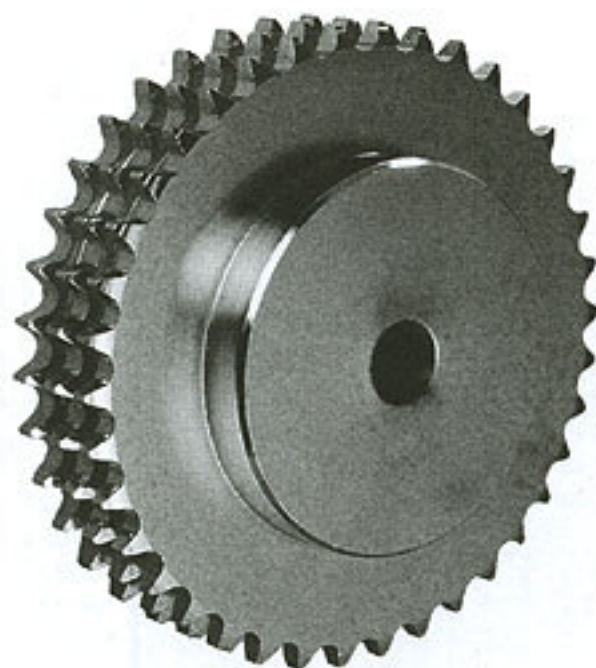

## Triple-Type B & C

No. Teeth	SZS Number	De	Type	D1		Dm	A	Weight Lbs. (Approx.)
				Min.	Max.			
11	E80B11H	4.010	B	1	1 $\frac{1}{4}$	2 $\frac{1}{2}$	3 $\frac{3}{8}$	5.9
12	E80B12H	4.330	B	1	1 $\frac{1}{4}$	2 $\frac{7}{32}$	3 $\frac{3}{8}$	7.5
13	E80B13H	4.660	B	1	2 $\frac{1}{4}$	3 $\frac{1}{2}$	3 $\frac{3}{8}$	9.2
14	E80B14H	4.980	B	1	2 $\frac{3}{8}$	3 $\frac{15}{32}$	3 $\frac{3}{8}$	11.0
15	E80B15H	5.300	B	1	2 $\frac{1}{2}$	3 $\frac{5}{16}$	3 $\frac{3}{8}$	13.1
16	E80B16H	5.630	B	1	2 $\frac{3}{4}$	4	3 $\frac{3}{8}$	15.8
17	E80B17H	5.950	B	1	3	4 $\frac{1}{4}$	3 $\frac{3}{8}$	18.6
18	E80B18H	6.270	B	1	3 $\frac{1}{4}$	4 $\frac{1}{4}$	3 $\frac{3}{8}$	21.2
19	E80B19H	6.590	B	1	3 $\frac{3}{8}$	5	3 $\frac{3}{8}$	23.7
20	E80B20H	6.910	B	1	3 $\frac{3}{8}$	5	3 $\frac{3}{8}$	26.0
21	E80B21H	7.240	B	1	3 $\frac{3}{8}$	5	3 $\frac{3}{8}$	28.4
22	E80B22H	7.560	B	1	3 $\frac{3}{8}$	5	3 $\frac{3}{8}$	31.0
23	E80B23H	7.880	B	1	3 $\frac{3}{8}$	5	3 $\frac{3}{8}$	33.6
24	E80B24H	8.200	B	1	3 $\frac{3}{8}$	5 $\frac{1}{4}$	3 $\frac{3}{8}$	37.1
25	E80B25H	8.520	B	1	3 $\frac{3}{8}$	5 $\frac{1}{4}$	3 $\frac{3}{8}$	40.1
26	E80B26	8.840	B	1	3 $\frac{3}{8}$	5 $\frac{1}{4}$	3 $\frac{3}{8}$	42.9
30	E80B30	10.110	B	1 $\frac{1}{4}$	3 $\frac{3}{8}$	5 $\frac{1}{4}$	4 $\frac{1}{4}$	54.5
35	E80B35	11.710	B	1 $\frac{1}{4}$	3 $\frac{3}{8}$	5 $\frac{1}{4}$	4 $\frac{1}{4}$	79.5
36	E80B36	12.030	B	1 $\frac{1}{4}$	3 $\frac{3}{8}$	5 $\frac{1}{4}$	4 $\frac{1}{4}$	83.9
42	E80C42	13.940	C	1 $\frac{1}{4}$	3 $\frac{3}{8}$	6	4 $\frac{1}{2}$	84.9
45	E80C45	14.900	C	1 $\frac{1}{4}$	3 $\frac{3}{8}$	6	4 $\frac{1}{2}$	92.4
52	E80C52	17.130	C	1 $\frac{1}{2}$	3 $\frac{3}{8}$	6	4 $\frac{1}{2}$	107
60	E80C60	19.680	C	1 $\frac{1}{2}$	4 $\frac{1}{4}$	6 $\frac{1}{4}$	4 $\frac{1}{2}$	128
68	E80C68	22.230	C	1 $\frac{1}{2}$	4 $\frac{1}{4}$	6 $\frac{1}{4}$	4 $\frac{1}{2}$	140
76	E80C76	24.780	C	1 $\frac{1}{2}$	4 $\frac{1}{4}$	6 $\frac{1}{4}$	4 $\frac{1}{2}$	165
95	E80C95	30.830	C	1 $\frac{1}{2}$	4 $\frac{1}{2}$	6 $\frac{1}{4}$	5	240



# No.100

# Stock Sprockets

Pitch  $1\frac{1}{4}$ "       Roller  $\Phi$   $0.750$ "  
 Tooth width B1  $0.692$ "

## Single-Type A

## Single-Type B & C

No. Teeth	De	Type	SZS Number	D1	Weight Lbs. (Approx.)	SZS Number	Type	D1		Dm	A	Weight Lbs. (Approx.)
								Min.	Max.			
7	3.350		100A7	1	1.2							
8	3.770		100A8	1	1.4	100B8	B	1	1 1/4	2 7/16*	1 1/8	2.3
9	4.180		100A9	1	1.6	100B9	B	1	1 1/8	2 1 1/8*	1 1/8	3.2
10	4.600		100A10	1	2.0	100B10	B	1	1 7/8	3 1/4*	1 1/8	4.1
11	5.010	A	100A11	1 1/4	2.5	100B11	B	1	2 1/4	3 3/16*	1 1/8	5.3
12	5.420	A	100A12	1 1/4	3.0	100B12	B	1	2 1/4	4*	1 1/8	6.4
13	5.820	A	100A13	1 1/4	3.5	100B13	B	1	2 3/8	3 3/8	1 1/8	6.6
14	6.230	A	100A14	1 1/4	4.1	100B14	B	1 1/4	2 3/4	4 3/16	1 1/8	7.4
15	6.630	A	100A15	1 1/4	4.7	100B15	B	1 1/4	3	4 1/2	1 1/4	9.2
16	7.030	A	100A16	1 1/4	5.4	100B16	B	1 1/8	3	4 1/2	1 1/4	9.9
17	7.440	A	100A17	1 1/4	6.1	100B17	B	1 1/8	3	4 1/2	1 1/4	10.8
18	7.840	A	100A18	1 1/4	7.0	100B18	B	1 1/8	3	4 1/2	1 1/4	11.5
19	8.240	A	100A19	1 1/4	7.8	100B19	B	1 1/8	3	4 1/2	2	13.1
20	8.640	A	100A20	1 1/4	8.8	100B20	B	1 1/8	3	4 1/2	2	14.2
21	9.040	A	100A21	1 1/4	9.8	100B21	B	1 1/8	3	4 1/2	2	15.3
22	9.440	A	100A22	1 1/4	10.5	100B22	B	1 1/8	3	4 1/2	2	16.1
23	9.840	A	100A23	1 1/4	11.8	100B23	B	1 1/4	3	4 1/2	2	17.2
24	10.250	A	100A24	1 1/4	12.8	100B24	B	1 1/4	3	4 1/2	2	19.2
25	10.650	A	100A25	1 1/4	13.9	100B25	B	1 1/4	3	4 1/2	2	19.5
26	11.050	A	100A26	1 1/4	15.0	100B26	B	1 1/4	3 3/16	5	2	21.7
27	11.440	A	100A27	1 1/4	16.0	100B27	B	1 1/4	3 3/16	5	2	23.0
28	11.840	A	100A28	1 1/4	17.4	100B28	B	1 1/4	3 3/16	5	2	24.4
29	12.240	A	100A29	1 1/4	19.6	100B29	B	1 1/4	3 3/16	5	2	25.0
30	12.640	A	100A30	1 1/4	20.1	100B30	B	1 1/4	3 3/16	5	2	26.9
31	13.040	A	100A31	1 1/4	21.5							
32	13.440	A	100A32	1 1/4	22.6	100B32	B	1 1/4	3 3/16	5	2	29.8
33	13.840	A	100A33	1 1/4	24.1							
34	14.240	A	100A34	1 1/4	26.0							
35	14.640	A	100A35	1 1/4	27.2	100B35	B	1 1/4	3 3/16	5	2 1/2	36.9
36	15.040	A	100A36	1 1/4	30.0	100B36	B	1 1/4	3 3/16	5	2 1/2	38.6
37	15.440	A	100A37	1 1/4	31.0							
38	15.840	A	100A38	1 1/4	33.0	100B38	B	1 1/4	3 3/16	5	2 1/2	41.5
39	16.230	A	100A39	1 1/4	35.0	100B39	B	1 1/4	3 3/16	5	2 1/2	43.6
40	16.630	A	100A40	1 1/4	36.0	100B40	B	1 1/4	3 3/16	5	2 1/2	46.9
41	17.030	A	100A41	1 1/4	39.0							
42	17.430	A	100A42	1 1/4	40.0	100B42	B	1 1/4	3 3/16	5	2 1/2	50.4
43	17.830	A	100A43	1 1/2	43.0							
44	18.230	A	100A44	1 1/2	45.0							
45	18.630	A	100A45	1 1/2	47.0	100B45	B	1 1/2	3 3/16	5	2 1/2	54.0
46	19.020	A	100A46	1 1/2	48.0							
47	19.420	A	100A47	1 1/2	52.0							
48	19.820	A	100A48	1 1/2	54.0	100B48	B	1 1/2	4	6	2 1/2	66.0
49	20.220	A	100A49	1 1/2	56.0							
50	20.620	A	100A50	1 1/2	57.0							
51	21.020	A	100A51	1 1/2	63.0							
52	21.420	A	100A52	1 1/2	64.0							
53	21.810	A	100A53	1 1/2	64.2							
54	22.210	A	100A54	1 1/2	68.0	100C54	C	1 1/2	4	6	3 1/4	78.0
55	22.610	A	100A55	1 1/2	70.0							
56	23.010	A	100A56	1 1/2	72.0							
57	23.410	A	100A57	1 1/2	75.8							
58	23.810	A	100A58	1 1/2	76.0							
59	24.200	A	100A59	1 1/2	77.0							
60	24.600	A	100A60	1 1/2	80.0	100C60	C	1 1/2	4	6	3 1/4	89.0
70	28.580	A	100A70	1 1/2	113	100C70	C	1 1/2	5 1/4	7	3 1/4	125
72	29.380	A	100A72	1 1/2	119	100C72	C	1 1/2	5 1/4	7	3 1/4	134
76	30.973	A	100A76	1 1/2	133	100C76	C	1 1/2	5 1/4	7	3 1/4	143
80	32.570	A	100A80	1 1/2	146	100C80	C	1 1/2	5 1/4	7	3 1/4	151
84	34.160	A	100A84	1 1/2	162	100C84	C	1 1/2	5 1/4	7	3 1/4	170
90	36.550	A	100A90	1 1/2	193	100C90	C	1 1/2	5 1/4	7	3 1/4	184
96	38.930	A	100A96	1 1/2	215	100C96	C	1 1/2	5 1/4	7	4 1/2	203

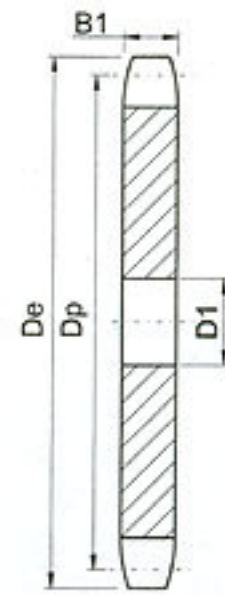

TYPE A

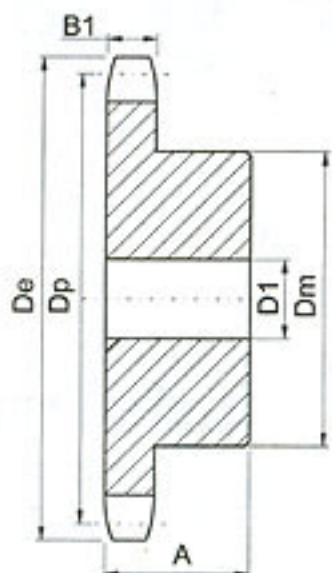

TYPE B

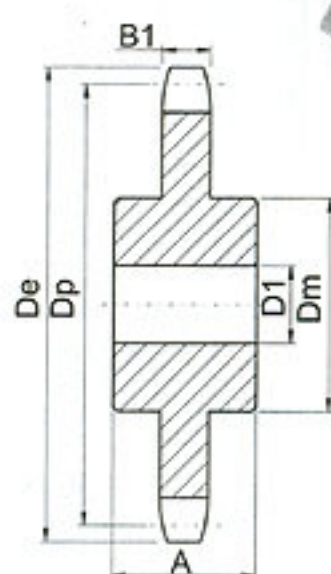

TYPE C

# No.100-2 Stock Sprockets

- Pitch  $1\frac{1}{4}''$        Roller  $\Phi$   $0.750''$   
 Tooth width b1  $0.669''$        Tooth width B2  $2.077''$

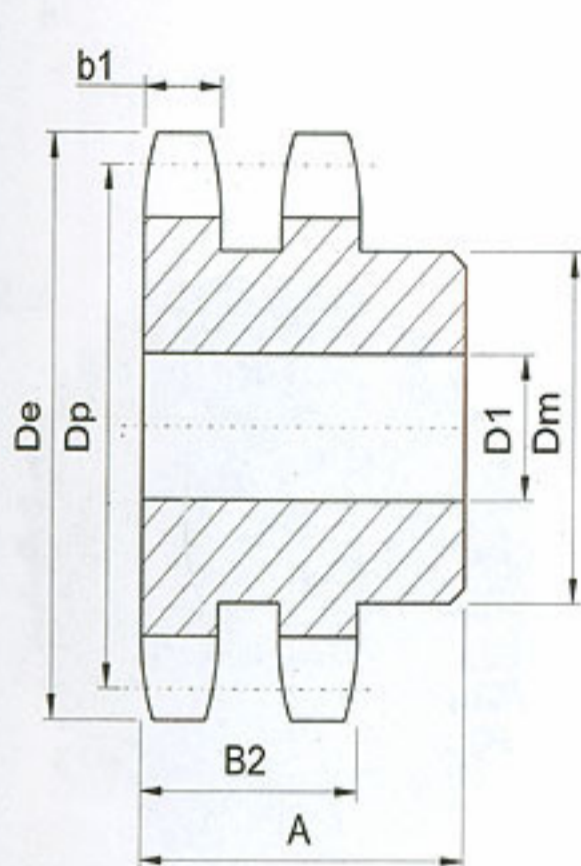

TYPE B

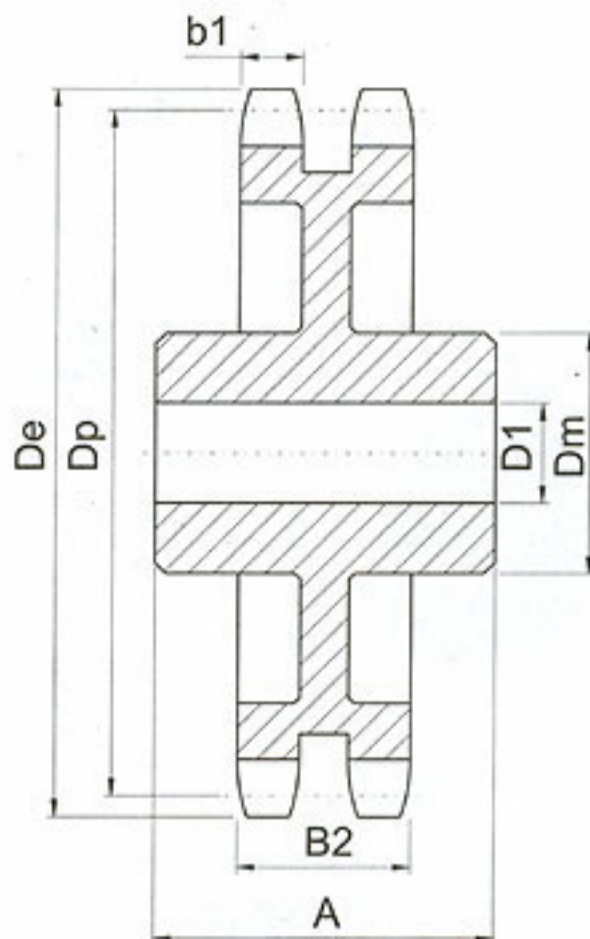

TYPE C

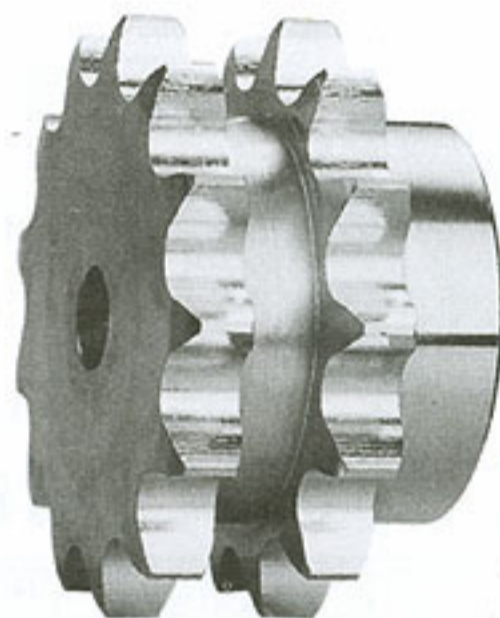

## Double-Type B & C

No. Teeth	SZS Number	De	Type	D1		Dm	A	Weight Lbs. (Approx.)
				Min.	Max.			
9	D100B9	4.180	B	1	1 $\frac{1}{8}$	2 $\frac{1}{2}$	2 $\frac{1}{2}$	4.6
10	D100B10	4.600	B	1	1 $\frac{1}{8}$	2 $\frac{1}{2}$	2 $\frac{1}{2}$	6.2
11	D100B11	5.010	B	1	2 $\frac{1}{8}$	3 $\frac{1}{2}$	2 $\frac{1}{2}$	7.9
12	D100B12	5.420	B	1 $\frac{1}{8}$	2 $\frac{1}{4}$	3 $\frac{1}{2}$	2 $\frac{1}{2}$	9.3
13	D100B13	5.820	B	1 $\frac{1}{8}$	2 $\frac{1}{2}$	3 $\frac{3}{8}$	2 $\frac{1}{2}$	11.4
14	D100B14	6.230	B	1 $\frac{1}{8}$	2 $\frac{1}{2}$	4 $\frac{1}{8}$	2 $\frac{1}{2}$	13.6
15	D100B15	6.630	B	1 $\frac{1}{8}$	3 $\frac{1}{8}$	4 $\frac{1}{8}$	3 $\frac{1}{8}$	17.1
16	D100B16	7.030	B	1 $\frac{1}{8}$	3 $\frac{1}{8}$	5	3 $\frac{1}{8}$	20.1
17	D100B17	7.440	B	1 $\frac{1}{8}$	3 $\frac{1}{2}$	5 $\frac{1}{4}$	3 $\frac{1}{8}$	23.1
18	D100B18	7.840	B	1 $\frac{1}{8}$	3 $\frac{1}{2}$	5 $\frac{1}{4}$	3 $\frac{1}{8}$	25.4
19	D100B19	8.240	B	1 $\frac{1}{8}$	3 $\frac{1}{2}$	5 $\frac{1}{2}$	3 $\frac{1}{8}$	29.6
20	D100B20	8.640	B	1 $\frac{1}{8}$	3 $\frac{1}{2}$	5 $\frac{1}{2}$	3 $\frac{1}{8}$	32.4
21	D100B21	9.040	B	1 $\frac{1}{8}$	3 $\frac{1}{2}$	5 $\frac{1}{2}$	3 $\frac{1}{8}$	35.3
22	D100B22	9.440	B	1 $\frac{1}{8}$	3 $\frac{1}{2}$	5 $\frac{1}{2}$	3 $\frac{1}{8}$	38.4
23	D100B23	9.840	B	1 $\frac{1}{8}$	3 $\frac{1}{2}$	5 $\frac{1}{2}$	3 $\frac{1}{8}$	41.3
24	D100B24	10.250	B	1 $\frac{1}{8}$	3 $\frac{1}{2}$	5 $\frac{1}{2}$	3 $\frac{1}{8}$	45.1
25	D100B25	10.650	B	1 $\frac{1}{8}$	3 $\frac{1}{2}$	5 $\frac{1}{2}$	3 $\frac{1}{8}$	48.5
26	D100B26	11.050	B	1 $\frac{1}{2}$	3 $\frac{1}{2}$	5 $\frac{1}{2}$	3 $\frac{1}{8}$	51.5
30	D100B30	12.640	B	1 $\frac{1}{2}$	3 $\frac{1}{2}$	5 $\frac{1}{2}$	3 $\frac{1}{8}$	65.0
35	D100C35	14.640	C	1 $\frac{1}{2}$	3 $\frac{3}{8}$	6	4 $\frac{1}{2}$	75.0
45	D100C45	18.630	C	1 $\frac{1}{2}$	3 $\frac{3}{8}$	6	4 $\frac{1}{2}$	103
60	D100C60	24.600	C	1 $\frac{1}{2}$	5 $\frac{1}{8}$	7 $\frac{1}{2}$	5	175
70	D100C70	28.580	C	1 $\frac{1}{2}$	5 $\frac{1}{8}$	7 $\frac{1}{2}$	5	197
80	D100C80	32.570	C	1 $\frac{1}{2}$	5 $\frac{1}{8}$	7 $\frac{1}{2}$	5	231

# No.100-3 Stock Sprockets

- Pitch  $1\frac{1}{4}$ "       Roller  $\phi$  0.750"  
 Tooth width b1 0.669"       Tooth width B2 2.077"       Tooth width B3 3.485"

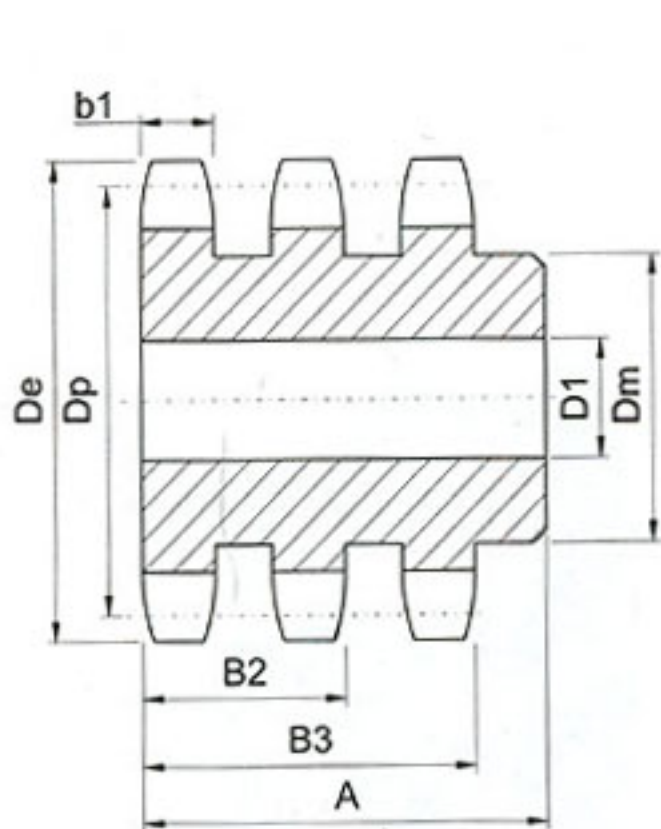

TYPE B

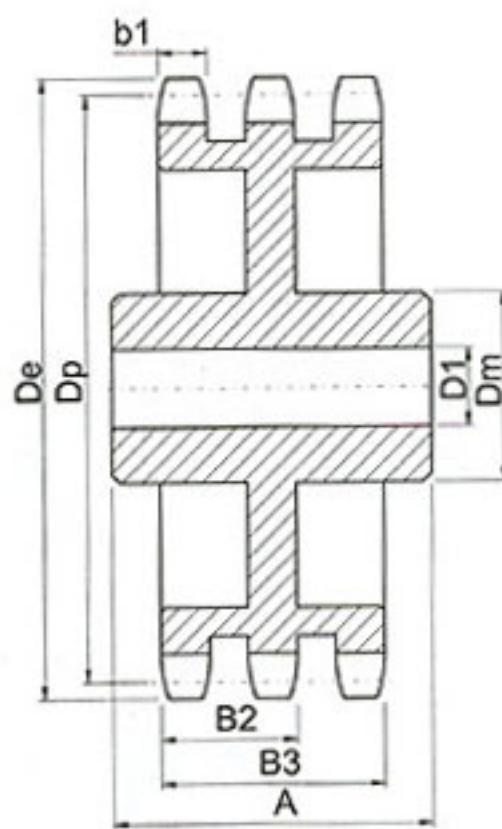

TYPE C



## Triple-Type B & C

No. Teeth	SZS Number	De	Type	D1		Dm	A	Weight Lbs. (Approx.)
				Min.	Max.			
11	E100B11	5.010	B	1	2 $\frac{1}{2}$	3 $\frac{1}{2}$	4 $\frac{1}{2}$	11.7
12	E100B12	5.420	B	1 $\frac{1}{4}$	2 $\frac{1}{2}$	3 $\frac{3}{8}$	4 $\frac{1}{2}$	13.7
13	E100B13	5.820	B	1 $\frac{1}{4}$	2 $\frac{1}{2}$	3 $\frac{7}{8}$	4 $\frac{1}{2}$	16.9
14	E100B14	6.230	B	1 $\frac{1}{4}$	2 $\frac{1}{2}$	4 $\frac{1}{8}$	4 $\frac{1}{2}$	20.2
15	E100B15	6.630	B	1 $\frac{1}{4}$	3 $\frac{1}{4}$	4 $\frac{1}{2}$	4 $\frac{1}{2}$	25.0
16	E100B16	7.030	B	1 $\frac{1}{4}$	3 $\frac{3}{8}$	5	4 $\frac{1}{2}$	29.3
17	E100B17	7.440	B	1 $\frac{1}{4}$	3 $\frac{1}{2}$	5 $\frac{1}{2}$	4 $\frac{1}{2}$	33.8
18	E100B18	7.840	B	1 $\frac{1}{4}$	3 $\frac{1}{2}$	5 $\frac{1}{2}$	4 $\frac{1}{2}$	38.6
19	E100B19	8.240	B	1 $\frac{1}{4}$	3 $\frac{3}{4}$	5 $\frac{3}{4}$	4 $\frac{1}{2}$	43.3
20	E100B20	8.640	B	1 $\frac{1}{4}$	3 $\frac{3}{4}$	5 $\frac{3}{4}$	4 $\frac{1}{2}$	47.9
21	E100B21	9.040	B	1 $\frac{1}{4}$	3 $\frac{3}{4}$	5 $\frac{3}{4}$	4 $\frac{1}{2}$	52.3
22	E100B22	9.440	B	1 $\frac{1}{4}$	3 $\frac{3}{4}$	5 $\frac{3}{4}$	4 $\frac{1}{2}$	57.5
23	E100B23	9.840	B	1 $\frac{1}{4}$	3 $\frac{3}{4}$	5 $\frac{3}{4}$	4 $\frac{1}{2}$	62.5
24	E100B24	10.250	B	1 $\frac{1}{4}$	3 $\frac{3}{4}$	5 $\frac{3}{4}$	4 $\frac{1}{2}$	69
25	E100B25	10.650	B	1 $\frac{1}{4}$	3 $\frac{3}{4}$	5 $\frac{3}{4}$	4 $\frac{1}{2}$	73
26	E100B26	11.050	B	1 $\frac{1}{2}$	3 $\frac{7}{8}$	5 $\frac{3}{4}$	4 $\frac{1}{2}$	79
30	E100B30	12.640	B	1 $\frac{1}{2}$	3 $\frac{7}{8}$	5 $\frac{3}{4}$	4 $\frac{1}{2}$	103
35	E100C35	14.640	C	1 $\frac{1}{2}$	4	6	5	108
45	E100C45	18.630	C	1 $\frac{1}{2}$	4	6	5	143
60	E100C60	24.600	C	1 $\frac{1}{2}$	5 $\frac{1}{2}$	7 $\frac{1}{2}$	5	217
70	E100C70	28.580	C	1 $\frac{1}{2}$	5 $\frac{1}{2}$	7 $\frac{1}{2}$	5	262
80	E100C80	32.570	C	1 $\frac{1}{2}$	5 $\frac{1}{2}$	7 $\frac{1}{2}$	5	313

- Pitch  $1\frac{1}{2}$ "
- Roller  $\phi$  0.875"
- Tooth width B1 0.924"

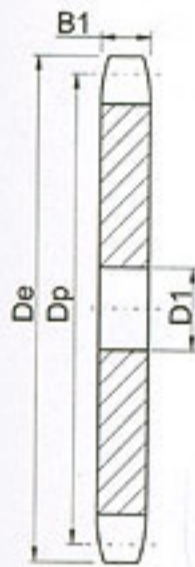

**TYPE A**

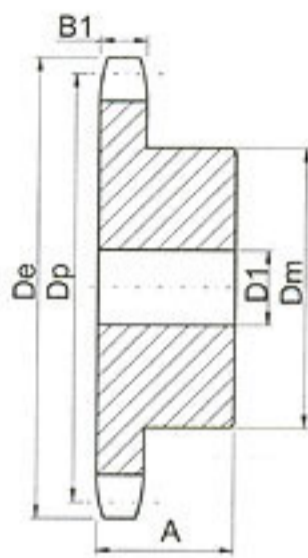

**TYPE B**

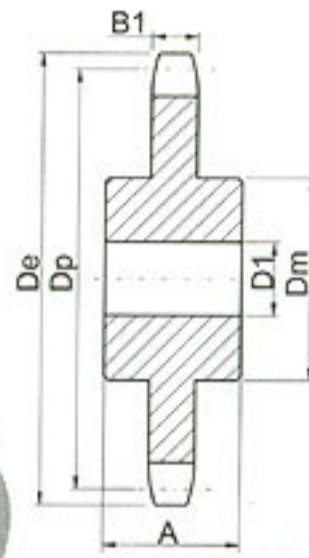

**TYPE C**

## Single-Type A

## Single-Type B & C

No. Teeth	De	Type	SZS Number	D1	Weight Lbs. (Approx.)	SZS Number	Type	D1		Dm	A	Weight Lbs. (Approx.)
								Min.	Max.			
8	4.520		120A8	1 1/4	2.4							
9	5.020	A	120A9	1 1/4	3.0	120B9	B	1 3/8	1 7/16	3 3/8★	2 1/4	5.3
10	5.520	A	120A10	1 1/4	3.8	120B10	B	1 3/8	2 1/4	3 3/8★	2 1/4	7.1
11	6.010	A	120A11	1 1/4	4.8	120B11	B	1 3/8	2 3/8	3 3/8	2 1/8	7.6
12	6.500	A	120A12	1 1/4	5.8	120B12	B	1 3/8	2 3/4	4 1/8	2 1/8	9.9
13	6.990	A	120A13	1 1/4	6.7	120B13	B	1 3/8	3	4 9/16	2 1/8	12.4
14	7.470	A	120A14	1 1/4	8.0	120B14	B	1 3/8	3 1/4	4 3/4	2 1/8	14.4
15	7.960	A	120A15	1 1/4	9.1	120B15	B	1 3/4	3 3/4	4 3/4	2 3/8	16.7
16	8.440	A	120A16	1 1/4	10.6	120B16	B	1 3/4	3 1/2	5 1/4	2 3/8	19.9
17	8.920	A	120A17	1 1/4	12.6	120B17	B	1 3/4	3 1/2	5 1/4	2 3/8	20.8
18	9.410	A	120A18	1 1/4	13.6	120B18	B	1 3/4	3 1/2	5 1/4	2 3/8	22.2
19	9.890	A	120A19	1 1/4	15.1	120B19	B	1 3/4	3 1/2	5 1/4	2 3/8	24.8
20	10.370	A	120A20	1 1/4	16.9	120B20	B	1 3/4	3 1/2	5 1/4	2 3/8	25.8
21	10.850	A	120A21	1 1/4	18.7	120B21	B	1 3/4	3 1/2	5 1/4	2 3/8	26.7
22	11.330	A	120A22	1 1/4	20.0	120B22	B	1 3/4	3 1/2	5 1/4	2 3/8	28.2
23	11.810	A	120A23	1 1/4	22.1	120B23	B	1 3/4	3 1/2	5 1/4	2 3/8	30.3
24	12.290	A	120A24	1 1/4	24.8	120B24	B	1 3/4	3 1/2	5 1/4	2 3/8	32.1
25	12.770	A	120A25	1 1/4	26.8	120B25	B	1 3/4	3 1/2	5 1/4	2 3/8	34.6
26	13.250	A	120A26	1 1/2	28.3	120B26	B	1 1/2	4	6	2 1/2	40.0
27	13.730	A	120A27	1 1/2	30.9							
28	14.210	A	120A28	1 1/2	33.6	120B28	B	1 1/2	4	6	2 1/2	44.9
30	15.170	A	120A30	1 1/2	39.0	120B30	B	1 1/2	4	6	2 1/2	50.2
32	16.130	A	120A32	1 1/2	43.9	120B32	B	1 1/2	4	6	2 1/2	56.0
33	16.610	A	120A33	1 1/2	48.2							
34	17.090	A	120A34	1 1/2	50							
35	17.570	A	120A35	1 1/2	52	120B35	B	1 1/2	4	6	2 1/2	62.4
36	18.050	A	120A36	1 1/2	56	120B36	B	1 1/2	4	6	2 1/2	66.4
40	19.960	A	120A40	1 1/2	71	120C40	C	1 1/2	4	6	3 3/4	92.0
42	20.920	A	120A42	1 1/2	75	120C42	C	1 1/2	4	6	3 3/4	98.0
45	22.350	A	120A45	1 1/2	88	120C45	C	1 1/2	4	6	3 3/4	99.2
48	23.790	A	120A48	1 1/2	103	120C48	C	1 1/2	4	6	4	113
54	26.650	A	120A54	1 1/2	140	120C54	C	1 1/2	4	6	4	133
60	29.520	A	120A60	1 1/2	160	120C60	C	1 1/2	5 1/4	7	4	160
70	34.300	A	120A70	1 1/2	216	120C70	C	1 1/2	5 3/8	7 1/2	4 1/2	206
80	39.080	A	120A80	1 1/2	284	120C80	C	1 1/2	5 3/8	7 1/2	4 1/2	254
90	43.850	A	120A90	1 1/2	358							

# No.120-2 Stock Sprockets

- Pitch  $1\frac{1}{2}$ "
- Roller  $\phi$  0.875"
- Tooth width b1 0.894"
- Tooth width B2 2.683"

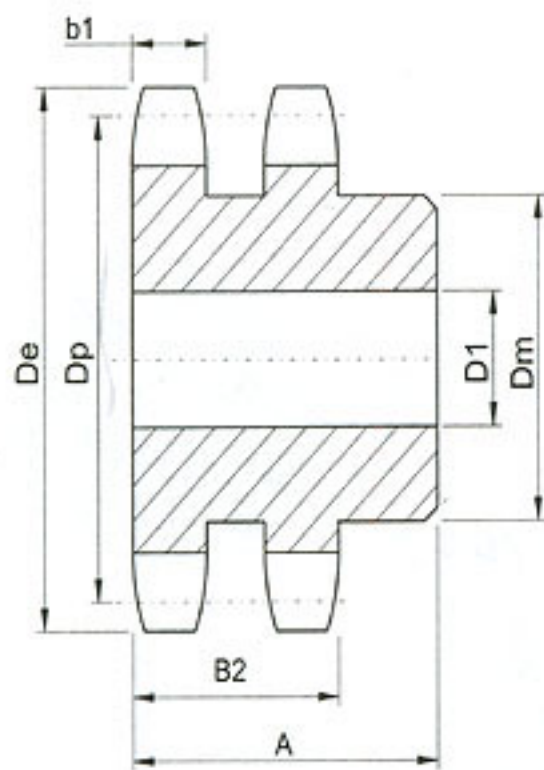

**TYPE B**

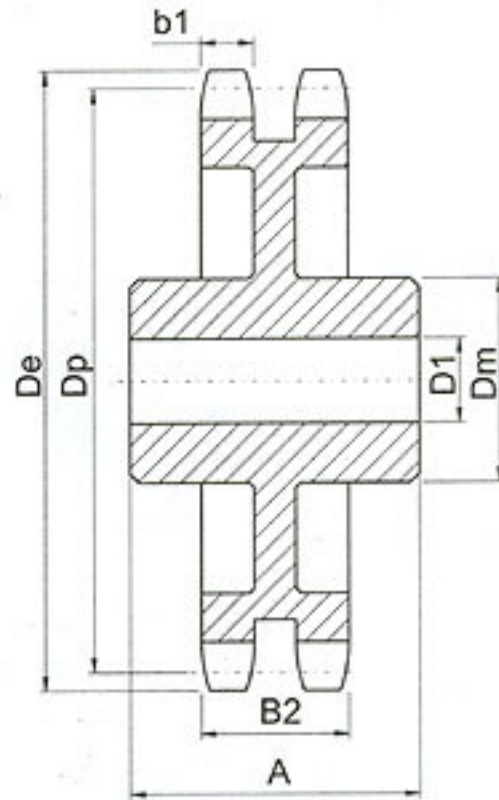

**TYPE C**

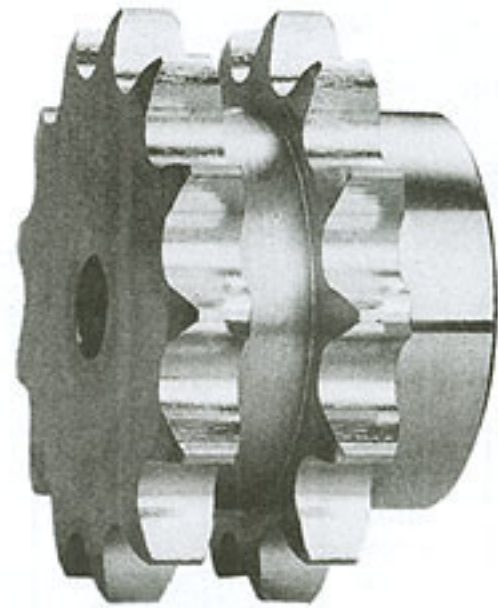

## Double-Type B & C

No. Teeth	SZS Number	De	Type	D1		Dm	A	Weight Lbs. (Approx.)
				Min.	Max.			
11	D120B11	6.010	B	1½	2%	3%	3%	13.6
12	D120B12	6.500	B	1½	2%	4%	3%	17.3
13	D120B13	6.990	B	1½	3	4½	3%	21.1
14	D120B14	7.470	B	1½	3%	5	3%	25.6
15	D120B15	7.960	B	1½	3%	5½	3%	29.9
16	D120B16	8.440	B	1½	3%	5½	3%	33.8
17	D120B17	8.920	B	1½	3%	5½	3%	36.9
18	D120B18	9.410	B	1½	3%	5½	3%	41.9
19	D120B19	9.890	B	1½	3%	5½	3%	46.5
20	D120B20	10.370	B	1½	3%	5½	3%	50.2
21	D120B21	10.850	B	1½	3%	5½	3%	55.6
22	D120B22	11.330	B	1½	3½	5½	4	64.0
23	D120B23	11.810	B	1½	4%	6%	4	75.0
24	D120B24	12.290	B	1½	4%	6%	4	79.0
25	D120B25	12.770	B	1½	4%	6%	4	84.0
26	D120B26	13.250	B	1½	4%	6%	4	90.0
30	D120B30	15.170	B	1½	4%	6%	4	119
35	D120C35	17.570	C	1½	5%	7%	6	148
45	D120C45	22.350	C	1½	5%	7½	6	188
60	D120C60	29.520	C	1½	6%	9%	6%	307

# No.140

# Stock Sprockets

- Pitch  $1\frac{3}{4}$ "
- Roller  $\Phi$  1.000"
- Tooth width b1 0.924"



TYPE A

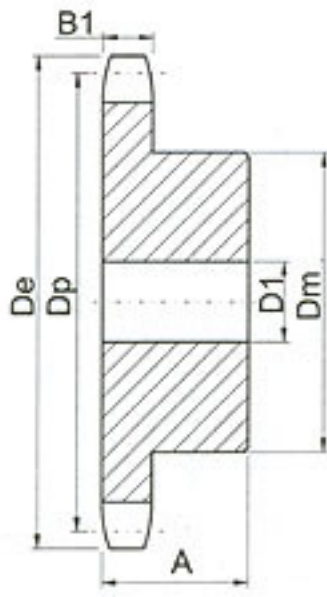

TYPE B

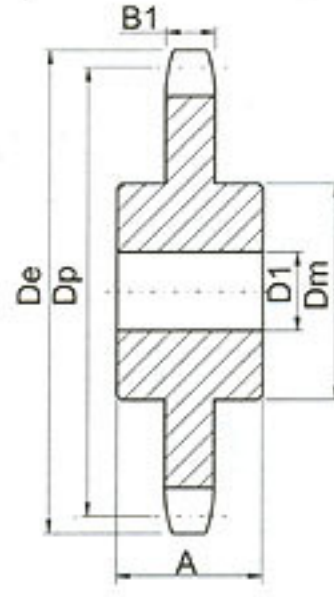

TYPE C



## Single-Type A

## Single-Type B & C

No. Teeth	De	Type	SZS Number	D1	Weight Lbs. (Approx.)	SZS Number	Type	D1		Dm	A	Weight Lbs. (Approx.)
								Min.	Max.			
11	7.010	A	140A11	1½	5.0	140B11	B	1½	2¾	4¼	2¼	11.3
12	7.580	A	140A12	1½	7.8	140B12	B	1½	3	4½	2¼	13.2
13	8.150	A	140A13	1½	8.2	140B13	B	1½	3¾	5½	2¾	18.9
14	8.720	A	140A14	1½	10.0	140B14	B	1½	3¾	5½	2¾	20.4
15	9.280	A	140A15	1½	11.0	140B15	B	1½	4¼	6¼	2¾	25.1
16	9.850	A	140A16	1½	14.0	140B16	B	1½	4¼	6¼	2½	27.9
17	10.410	A	140A17	1½	16.0	140B17	B	1½	4¼	6¼	2½	29.8
18	10.980	A	140A18	1½	18.0	140B18	B	1½	4¼	6¼	2½	32.0
19	11.540	A	140A19	1½	21.0	140B19	B	1½	4¼	6¼	2½	34.1
20	12.100	A	140A20	1½	23.0	140B20	B	1½	4¼	6¼	2½	36.0
21	12.660	A	140A21	1½	25.0	140B21	B	1½	4¼	6¼	2½	38.7
22	13.220	A	140A22	1½	28.0	140B22	B	1½	4¼	6¼	2½	40.6
23	13.780	A	140A23	1½	30.0	140B23	B	1½	4¼	6¼	2½	42.1
24	14.340	A	140A24	1½	33.0	140B24	B	1½	4¼	6¼	2½	46.2
25	14.900	A	140A25	1½	34.0	140B25	B	1½	4¼	6¼	2½	47.8
26	15.460	A	140A26	1½	39.0	140B26	B	1½	4¼	6¼	3	57.2
27	16.020	A	140A27	1½	41.0	140B27	B	1½	4¼	6¼	3	58.5
28	16.580	A	140A28	1½	45.0	140B28	B	1½	4¼	6¼	3	62.2
30	17.700	A	140A30	1½	52.0	140B30	B	1½	4¼	6¼	3	69.8
31	18.260	A	140A31	1½	56.0							
32	18.820	A	140A32	1½	60.0	140B32	B	1½	4¼	6¼	3	76.3
35	20.490	A	140A35	1½	73.0	140C35	C	1½	5¼	7	4	108
36	21.050	A	140A36	1½	77.0							
40	23.290	A	140A40	1½	93.0	140C40	C	1½	5¼	7	4	121
45	26.080	A	140A45	1½	131	140C45	C	1½	5¼	7	4	142
48	27.750	A	140A48	1½	134	140C48	C	1½	5¼	7	4	150
54	31.100	A	140A54	1½	173	140C54	C	1½	5¼	7	4	177
60	34.440	A	140A60	1½	219	140C60	C	1½	5¼	7	5	220
70	40.020	A	140A70	1½	292	140C70	C	1½	5¾	7½	5	282
80	45.590	A	140A80	1½	402	140C80	C	1½	5¾	7½	5	331

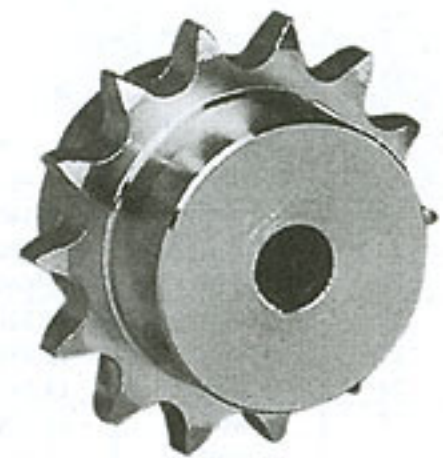
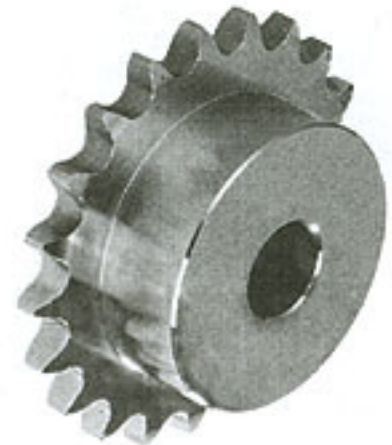

# No.140-2 Stock Sprockets

- Pitch  $1\frac{3}{4}$ "
- Roller  $\phi$  1.000"
- Tooth width b1 0.894"
- Tooth width B2 2.818"

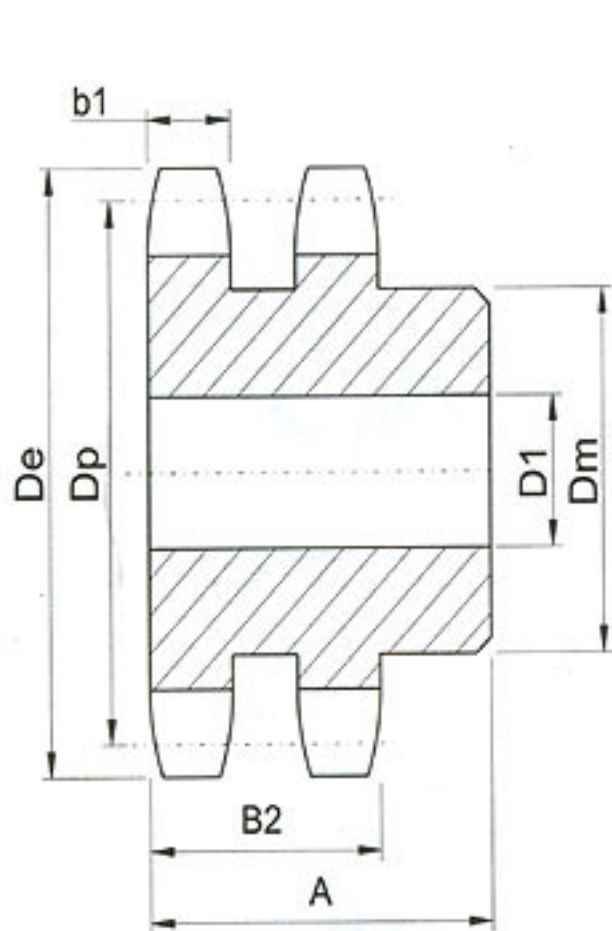

**TYPE B**

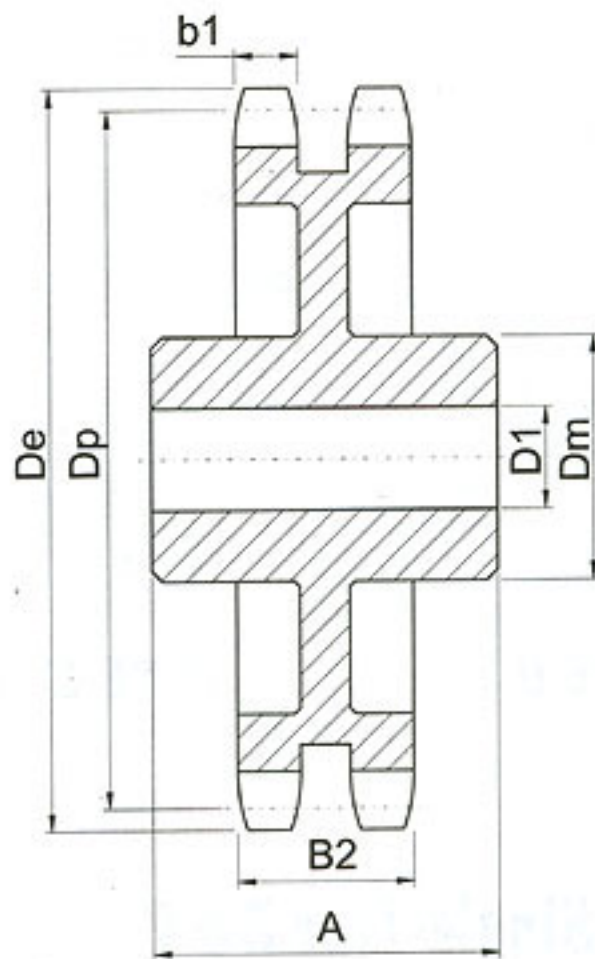

**TYPE C**

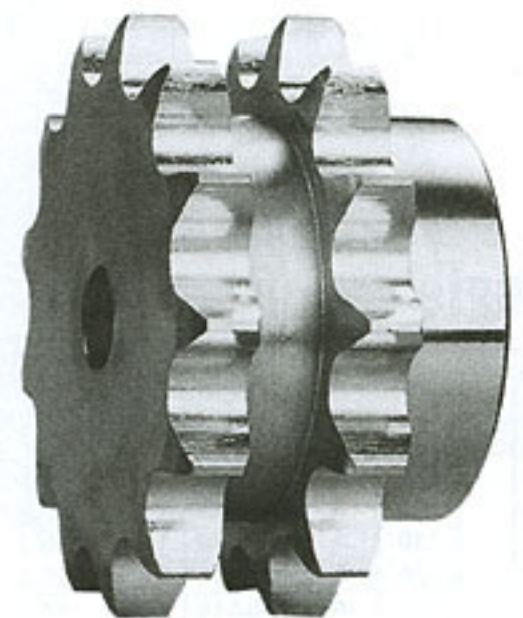

## Double-Type B & C

No. Teeth	SZS Number	De	Type	D1		Dm	A	Weight Lbs. (Approx.)
				Min.	Max.			
13	D140B13	8.150	B	1 $\frac{1}{2}$	3 $\frac{3}{16}$	5	3 $\frac{3}{8}$	29
14	D140B14	8.720	B	1 $\frac{1}{2}$	3 $\frac{3}{8}$	5 $\frac{1}{2}$	3 $\frac{3}{8}$	34.8
15	D140B15	9.280	B	1 $\frac{1}{2}$	4 $\frac{1}{2}$	6 $\frac{1}{2}$	3 $\frac{3}{8}$	42.5
16	D140B16	9.850	B	1 $\frac{1}{2}$	5 $\frac{1}{8}$	7	4	48.1
17	D140B17	10.410	B	1 $\frac{1}{2}$	5 $\frac{1}{8}$	7	4	57.5
18	D140B18	10.980	B	1 $\frac{1}{2}$	5 $\frac{1}{8}$	7	4	65.6
19	D140B19	11.540	B	1 $\frac{1}{2}$	5 $\frac{1}{8}$	7	4	72.0
20	D140B20	12.100	B	1 $\frac{1}{2}$	5 $\frac{1}{8}$	7	4	76.0
21	D140B21	12.660	B	1 $\frac{1}{2}$	5 $\frac{1}{8}$	7	4	82.0
22	D140B22	13.220	B	1 $\frac{1}{2}$	5 $\frac{1}{8}$	7	4	94.0
23	D140B23	13.780	B	1 $\frac{1}{2}$	5 $\frac{1}{8}$	7	4	100
24	D140B24	14.340	B	1 $\frac{1}{2}$	5 $\frac{1}{8}$	7	4	104
25	D140B25	14.900	B	1 $\frac{1}{2}$	5 $\frac{1}{8}$	7	4	120
26	D140B26	15.460	B	1 $\frac{1}{2}$	5 $\frac{1}{8}$	7	4	128
35	D140C35	20.490	C	1 $\frac{1}{2}$	5 $\frac{1}{8}$	7 $\frac{1}{2}$	6	180
45	D140C45	26.080	C	1 $\frac{1}{2}$	5 $\frac{1}{8}$	7 $\frac{1}{2}$	6	232
60	D140C60	34.440	C	1 $\frac{1}{2}$	6 $\frac{1}{8}$	9 $\frac{1}{2}$	6 $\frac{1}{4}$	372

# No.160

# Stock Sprockets

- Pitch **2"**       Roller  $\Phi$  **1.125"**  
 Tooth width B1 **1.156"**

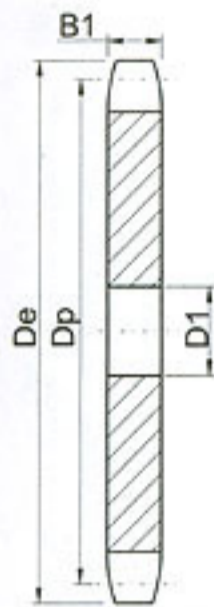

**TYPE A**

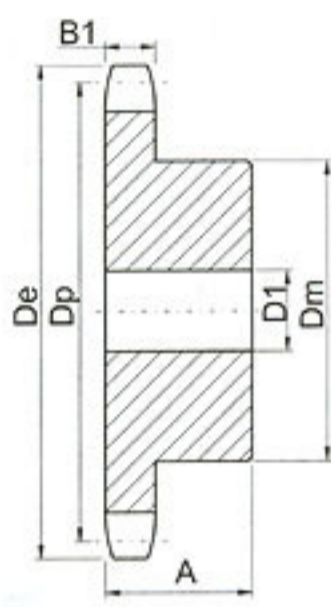

**TYPE B**

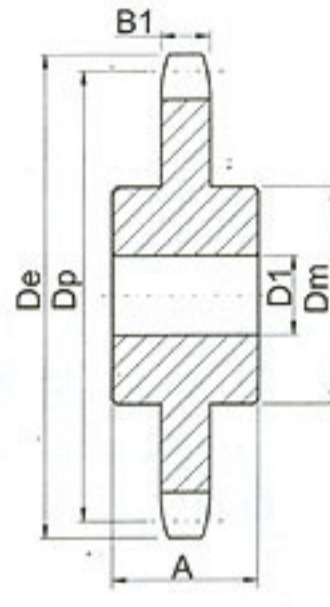

**TYPE C**

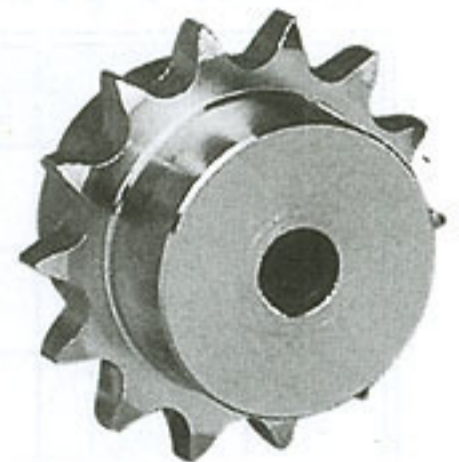

## Single-Type A

## Single-Type B & C

No. Teeth	De	Type	SZS Number	D1	Weight Lbs. (Approx.)	SZS Number	Type	D1		Dm	A	Weight Lbs. (Approx.)
								Min.	Max.			
8	6.030	A	160A8	1½	5.0	160B8	B	1½	1⅝	¾	2¼	8.0
9	6.700	A	160A9	1½	7.0	160B9	B	1½	2⅞	¾	2¼	10.0
10	7.360	A	160A10	1½	8.0	160B10	B	1½	2⅞	4⅞	2¼	12.0
11	8.010	A	160A11	1½	10.0	160B11	B	1½	3¼	4¾	2½	17.0
12	8.660	A	160A12	1½	12.0	160B12	B	1½	3¼	5½	2½	21.0
13	9.310	A	160A13	1½	16.0	160B13	B	1½	4	6	2¾	28.0
14	9.960	A	160A14	1½	17.0	160B14	B	1½	4½	6½	2¾	32.0
15	10.610	A	160A15	1½	21.0	160B15	B	1½	5¼	7	2¾	37.0
16	11.260	A	160A16	1½	24.0	160B16	B	1½	5¼	7	2¾	41.0
17	11.900	A	160A17	1½	27.0	160B17	B	1½	5¼	7	2¾	45.0
18	12.540	A	160A18	1½	30.0	160B18	B	1½	5¼	7	2¾	48.0
19	13.190	A	160A19	1½	34.0	160B19	B	1½	5¼	7	2¾	52.0
20	13.830	A	160A20	1½	38.0	160B20	B	1½	5¼	7	2¾	56.0
21	14.470	A	160A21	1½	42.0	160B21	B	1½	5¼	7	2¾	59.0
22	15.110	A	160A22	1½	46.0	160B22	B	1½	5¼	7	2¾	65.0
23	15.750	A	160A23	1½	50.0	160B23	B	1½	5¼	7	2¾	68.0
24	16.390	A	160A24	1½	56.0	160B24	B	1½	5¼	7	3	77.0
25	17.030	A	160A25	1½	61.0	160B25	B	1½	5¼	7	3	81.0
26	17.670	A	160A26	1½	65.0	160B26	B	1½	5¼	7	3	86.0
27	18.310	A	160A27	1½	71.0	160B27	B	1½	5¼	7	3	91.0
28	18.950	A	160A28	1½	77.0	160B28	B	1½	5¼	7	3	98.0
30	20.230	A	160A30	1½	90.0	160B30	B	1½	5¼	7	3	108
35	23.420	A	160A35	1½	121	160C35	C	1½	5½	8	4½	154
40	26.610	A	160A40	1½	138	160C40	C	1½	5½	8	4½	196
45	29.800	A	160A45	1½	204	160C45	C	1½	5½	8	5	234
54	35.540	A	160A54	1½	294	160C54	C	1½	5½	8	5	276
60	39.360	A	160A60	1½	366	160C60	C	1½	5½	8	5	329
70	45.730	A	160A70	1½	507	160C70	C	1½	5½	8	5	446
80	52.100	A	160A80	1½	656	160C80	C	1½	5½	8	6	612

## Single-Type B & C

No. Teeth	SZS Number	De	D1		Dm	A	Weight Lbs. (Approx.)
			Min.	Max.			
11	160C11	8.010	1½	¾	4½	4⅞	21
12	160C12	8.660	1½	¾	5½	4⅞	26



# No.160-2 Stock Sprockets

- Pitch 2"       Roller  $\phi$  1.125"  
 Tooth width b1 1.119"       Tooth width B2 3.424"

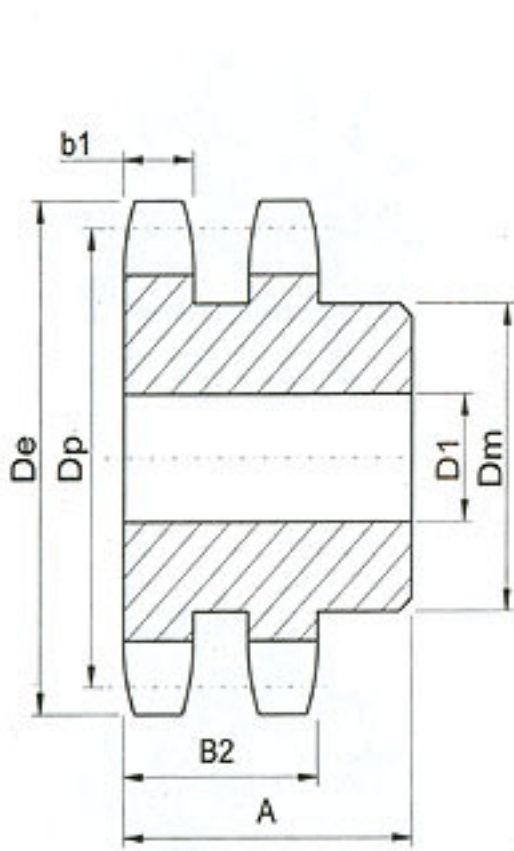

TYPE B

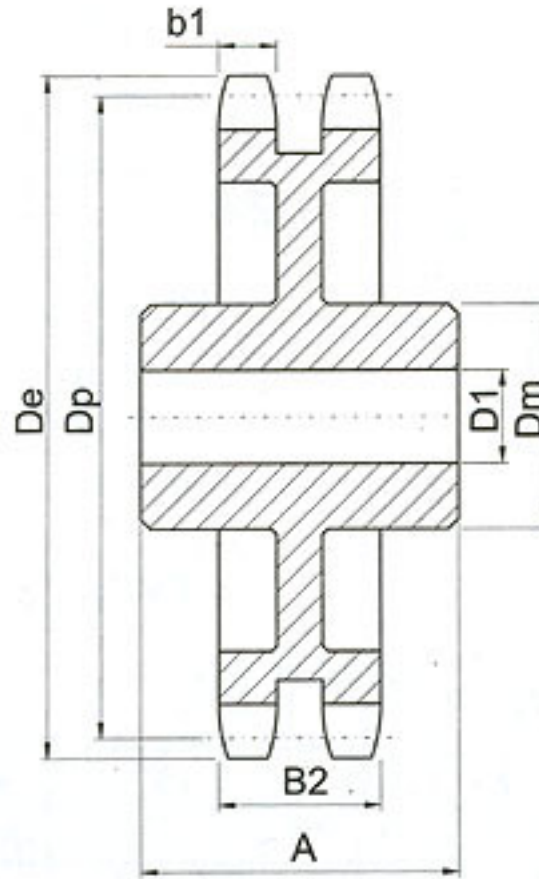

TYPE C

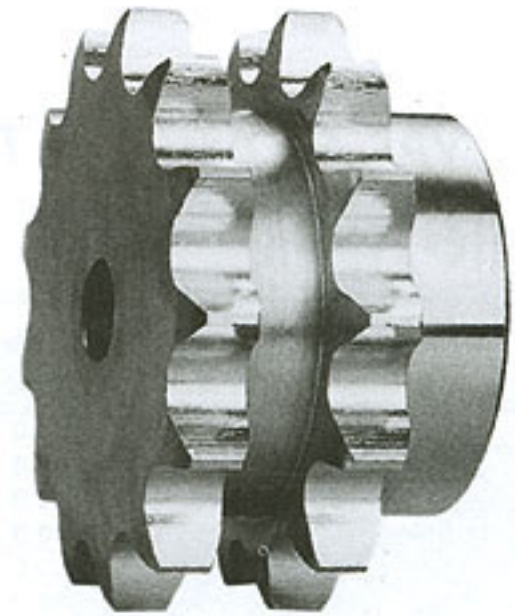

## Double-Type B & C

No. Teeth	SZS Number	De	Type	D1		Dm	A	Weight Lbs. (Approx.)
				Min.	Max.			
13	D160B13	9.310	B	2	4	6	4%	48
14	D160B14	9.960	B	2	4%	6%	4%	58
15	D160B15	10.610	B	2	5%	7	4%	68
16	D160B16	11.260	B	2	5%	7	4%	75
17	D160B17	11.900	B	2	5%	7	4%	91
18	D160B18	12.540	B	2	5%	7	4%	96
19	D160B19	13.190	B	2	5%	7	4%	107
20	D160B20	13.830	B	2	5%	7	4%	119
21	D160B21	14.470	B	2	5%	7½	4%	130
22	D160B22	15.110	B	2	5%	7½	4%	141
23	D160B23	15.750	B	2	5%	7½	4%	157
24	D160B24	16.390	B	2	5%	7½	4%	171
25	D160B25	17.030	B	2	5%	7½	4%	187
26	D160B26	17.670	B	2	5%	7½	4%	201
35	D160C35	23.420	C	1½	6%	9½	6%	306
45	D160C45	29.800	C	1½	7	10	7%	431
60	D160C60	39.360	C	1½	7	10	7%	564